

# SCHEDULE "A"

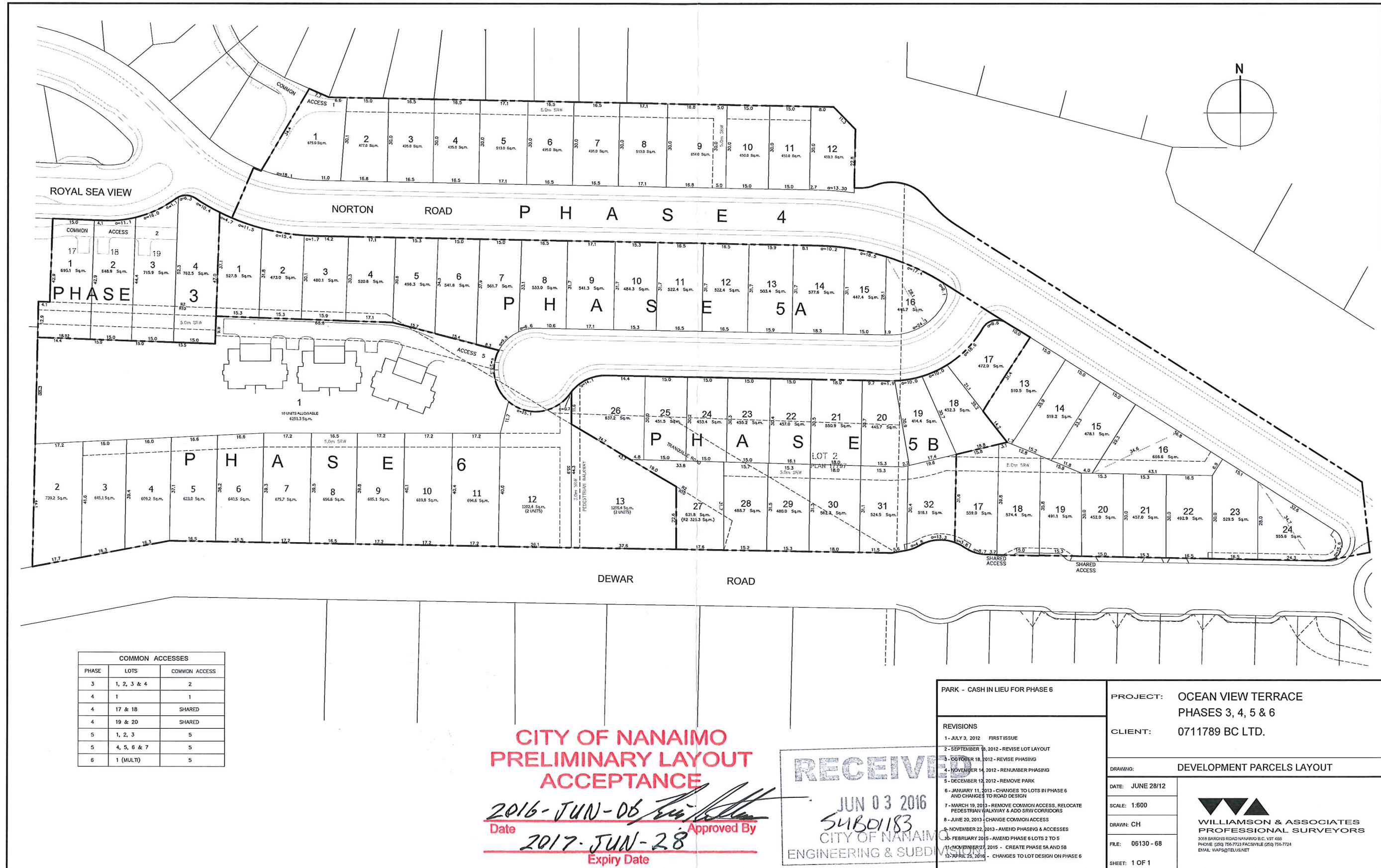

COMMON ACCESSES		
PHASE	LOTS	COMMON ACCESS
3	1, 2, 3 & 4	2
4	1	1
4	17 & 18	SHARED
4	19 & 20	SHARED
5	1, 2, 3	5
5	4, 5, 6 & 7	5
6	1 (MULTI)	5

**CITY OF NANAIMO  
PRELIMINARY LAYOUT  
ACCEPTANCE**

*2016-JUN-06*  
Date Approved By  
*2017-JUN-28*  
Expiry Date

**RECEIVED**  
JUN 03 2016  
SUB0183  
CITY OF NANAIMO  
ENGINEERING & SUBDIVISION

PARK - CASH IN LIEU FOR PHASE 6	
REVISIONS	
1-	JULY 3, 2012 - FIRST ISSUE
2-	SEPTEMBER 10, 2012 - REVISE LOT LAYOUT
3-	OCTOBER 18, 2012 - REVISE PHASING
4-	NOVEMBER 14, 2012 - RENUMBER PHASING
5-	DECEMBER 12, 2012 - REMOVE PARK
6-	JANUARY 11, 2013 - CHANGES TO LOTS IN PHASE 6 AND CHANGES TO ROAD DESIGN
7-	MARCH 19, 2013 - REMOVE COMMON ACCESS, RELOCATE PEDESTRIAN WALKWAY & ADD SRW CORRIDORS
8-	JUNE 20, 2013 - CHANGE COMMON ACCESS
9-	NOVEMBER 22, 2013 - AMEND PHASING & ACCESSES
10-	FEBRUARY 2015 - AMEND PHASE 6 LOTS 2 TO 5
11-	NOVEMBER 27, 2015 - CREATE PHASE 5A AND 5B
12-	APRIL 25, 2016 - CHANGES TO LOT DESIGN ON PHASE 6

PROJECT:	OCEAN VIEW TERRACE PHASES 3, 4, 5 & 6
CLIENT:	0711789 BC LTD.
DRAWING:	DEVELOPMENT PARCELS LAYOUT
DATE:	JUNE 28/12
SCALE:	1:600
DRAWN:	CH
FILE:	06130 - 68
SHEET:	1 OF 1

**WILLIAMSON & ASSOCIATES  
PROFESSIONAL SURVEYORS**  
3018 BARRIS ROAD NANAIMO B.C. V1T 4B5  
PHONE (250) 756-7723 FACSIMILE (250) 756-7724  
EMAIL: WAFS@TELUS.NET