

LOCATION PLAN

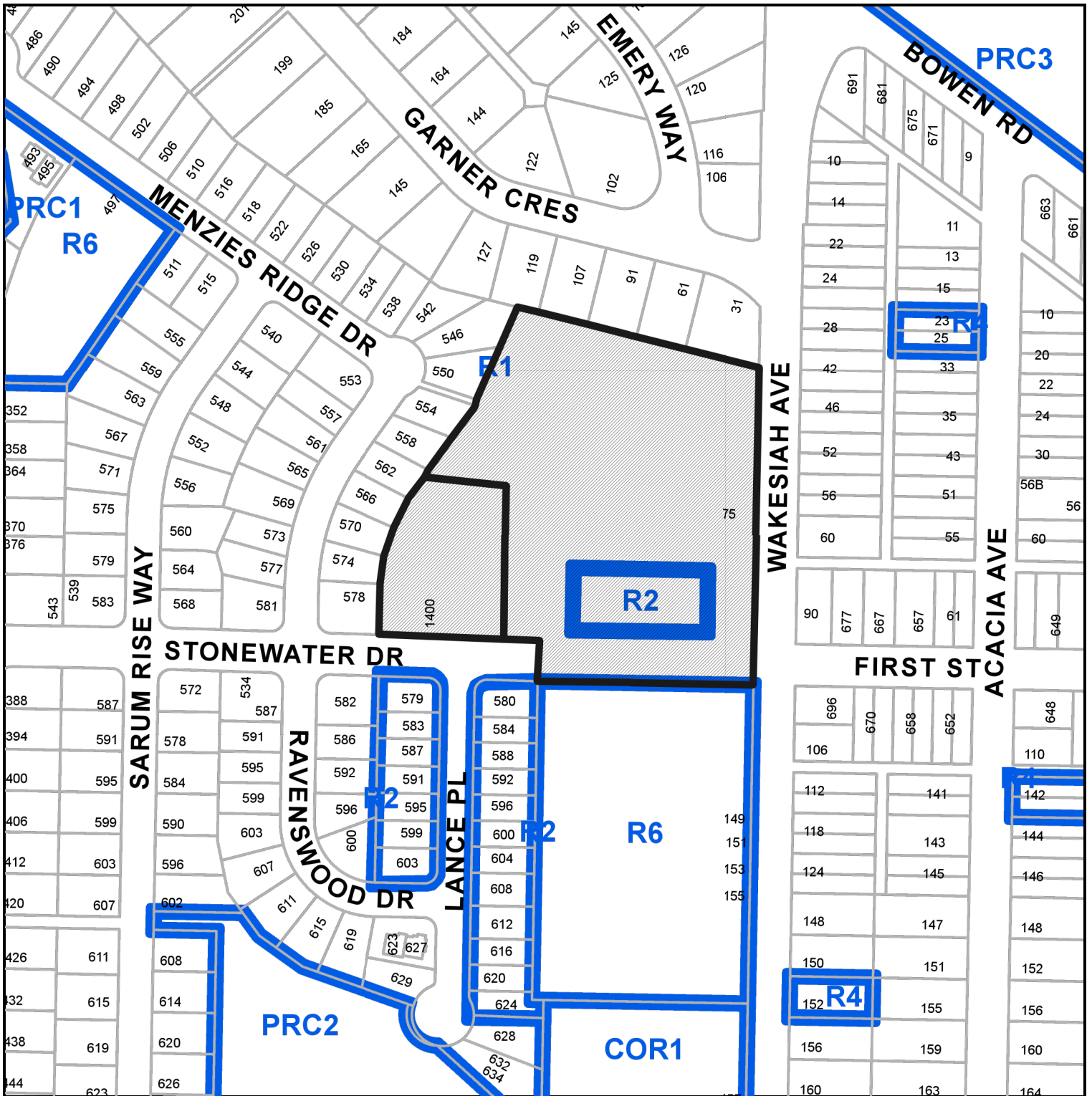

REZONING APPLICATION NO. RA000460

CIVIC: 75 WAKESIAH AVENUE & 1400 JINGLE POT ROAD

LEGAL: LOT B, SECTION 1, NANAIMO, PLAN VIP63268, EXCEPT PART IN PLANS EPP73244 AND EPP73656, LOT 1, SECTION 1, NANAIMO DISTRICT, PLAN VIP79548 EXCEPT PART IN PLAN VIP79549, VIP82272, VIP87165, EPP73244 AND EPP73656



Subject Property