



**DEVELOPMENT VARIANCE PERMIT NO. DVP00439**

**STEVEN ELLIS  
GISELLE SHANGI-ELLIS  
Owner(s) of Land (Permittee)**

**6566 KESTREL CRESCENT  
Civic Address**

1. This development variance permit is issued subject to compliance with all of the bylaws of the municipality applicable thereto, except as specifically varied by this permit.
2. This permit applies to and only to those lands within the municipality described below, and any and all buildings, structures and other developments thereon:

Legal Description:

**LOT 12, DISTRICT LOT 53, WELLINGTON DISTRICT, PLAN VIP75159  
PID No. 025-644-050**

3. The land described herein shall be developed strictly in accordance with the following terms and conditions and provisions of this permit, and any plans and specifications hereto shall form a part thereof.

**Schedule A Subject Property Map  
Schedule B Site Survey**

4. The "City of Nanaimo Zoning Bylaw 2011 No. 4500" is hereby varied as follows:
  - *Section 7.5.1 Siting of Buildings* – to reduce the minimum required rear yard setback from 7.5m to 6.19m for the proposed development.
  - *Section 7.6.1 Size of Buildings* – to increase the maximum allowable lot coverage from 40% to 41% for the proposed development.
5. If the landowner does not substantially start any construction with respect to which this permit was issued within two years after the date it was issued, the permit lapses.
6. This permit prevails over the provisions of the bylaw in the event of conflict.
7. This permit is not a building permit nor does it constitute approval of any signage. Separate applications must be made for a building permit and sign permit, if applicable.

**CONDITION OF PERMIT**

1. The subject property shall be developed in accordance with the Site Survey, prepared by Turner & Associates Land Surveying Inc., dated 2022-OCT-14, as shown in Schedule B.

AUTHORIZING RESOLUTION PASSED BY COUNCIL  
THE 21ST DAY OF NOVEMBER, 2022.

  
\_\_\_\_\_  
DJ Corporate Officer

  
\_\_\_\_\_  
Date

PC/bb  
Prospero attachment: DVP00439

**SUBJECT PROPERTY MAP**

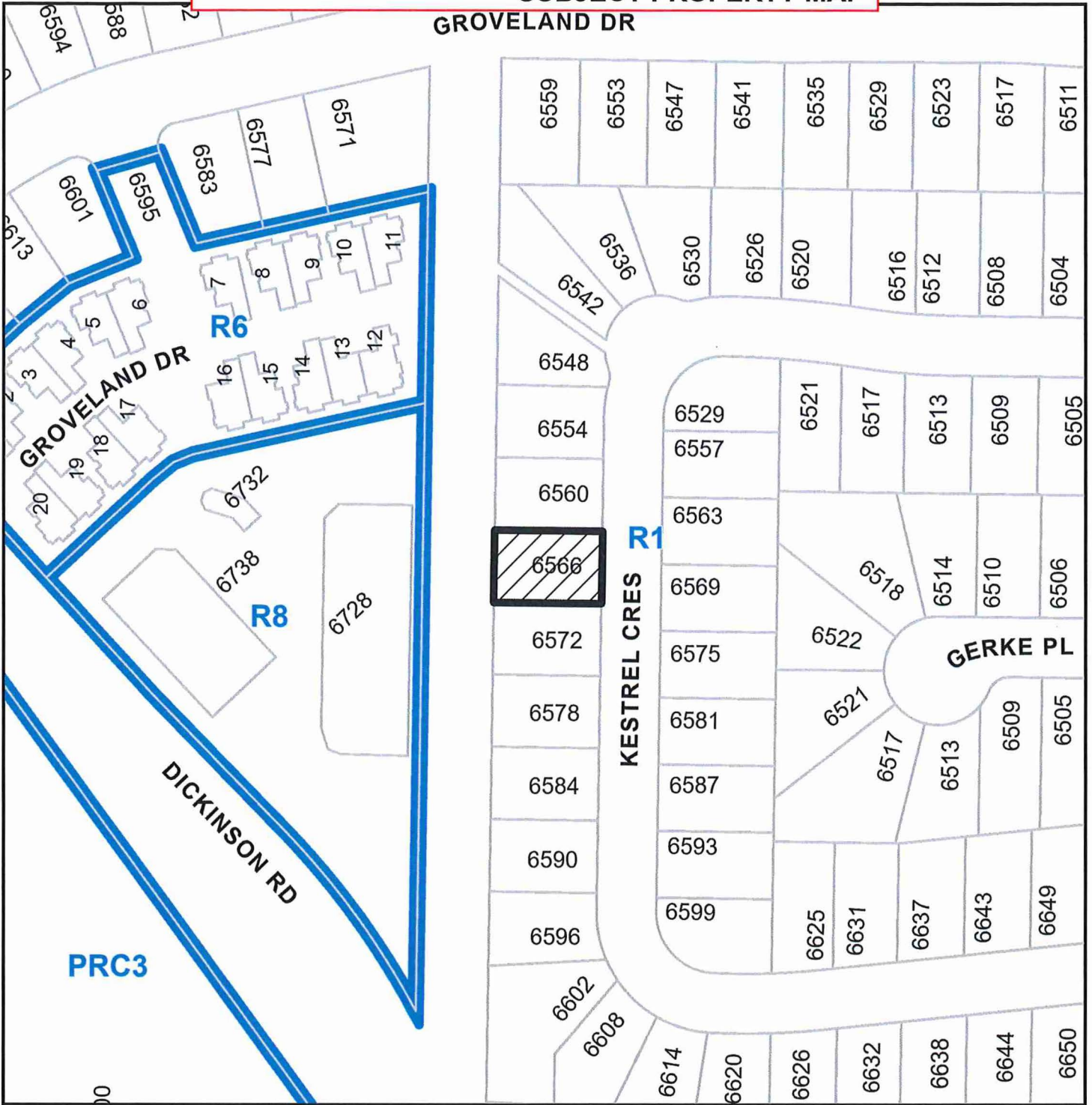

**DEVELOPMENT VARIANCE PERMIT APPLICATION NO. DVP00439**



6566 KESTREL CRESCENT

