



DEVELOPMENT VARIANCE PERMIT NO. DVP00434

THE BOARD OF EDUCATION OF SCHOOL DISTRICT NO. 68

Name of Owner(s) of Land (Permittee)

6135 MCGIRR ROAD

Civic Address:

1. This development variance permit is issued subject to compliance with all of the bylaws of the municipality applicable thereto, except as specifically varied by this permit.
2. This permit applies to and only to those lands within the municipality described below, and any and all buildings, structures and other developments thereon:

Legal Description:

**LOT A, DISTRICT LOT 48, WELLINGTON DISTRICT, PLAN VIP52017
EXCEPT PART IN PLAN VIP68657**

PID No. 017-138-809

3. The land described herein shall be developed strictly in accordance with the following terms and conditions and provisions of this permit, and any plans and specifications hereto shall form a part thereof.

Schedule A Location Plan

Schedule B Site Plan

Schedule C Sign Drawings

**Schedule D LED/Animated Signs – Development Variance Permit
Guidelines**

4. The City of Nanaimo "SIGN BYLAW 1987 NO. 2850" is hereby varied as follows:
 - *Section 3(22) General Provisions* – to allow an LED sign substantially as shown on Schedule C.
5. If the landowner does not substantially start any construction with respect to which this permit was issued within two years after the date it was issued, the permit lapses.
6. This permit prevails over the provisions of the bylaw in the event of conflict.

7. This permit is not a building permit nor does it constitute approval of any signage. Separate applications must be made for a building permit and sign permit.

CONDITIONS OF PERMIT

1. The proposed freestanding sign shall be located generally as shown on the Site Plan received 2022-MAY-31, as shown in Schedule B.
2. The proposed freestanding sign shall be constructed substantially in compliance with the Sign Drawings received 2022-MAR-16, as shown in Schedule C.
3. The LED portions of the proposed sign are limited to static images only which must be displayed for a minimum display period of six seconds per image. The use of animation effects to transition from one static image to the next will be permitted. Maximum transition time is three seconds. Continuous video, flashing or scrolling type signs are not permitted.
4. The LED portions of the proposed sign must include automatic dimming so that light intensity levels are automatically adjusted based on current weather conditions and the time of day.
5. The brightness level of the LED portions of the proposed sign shall not be more than 0.3 foot candles over ambient levels, as measured using a foot candle meter at a distance of 30m from the face of the sign.
6. The LED portions of the proposed sign must be turned off between the hours of 10:00 p.m. and 6:00 a.m.
7. The existing freestanding sign on the Hammond Bay Road frontage is to be removed with the installation of the proposed sign.
8. Low maintenance landscaping is to be installed at the base of the proposed freestanding sign.

AUTHORIZING RESOLUTION PASSED BY COUNCIL
THE 20TH DAY OF JUNE, 2022.

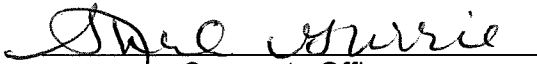

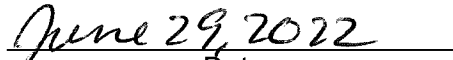
Corporate Officer

Date

CH/mb/lm
Prospero attachment: DVP00434

Development Variance Permit DVP00434 Schedule A
 6135 McGirr Road

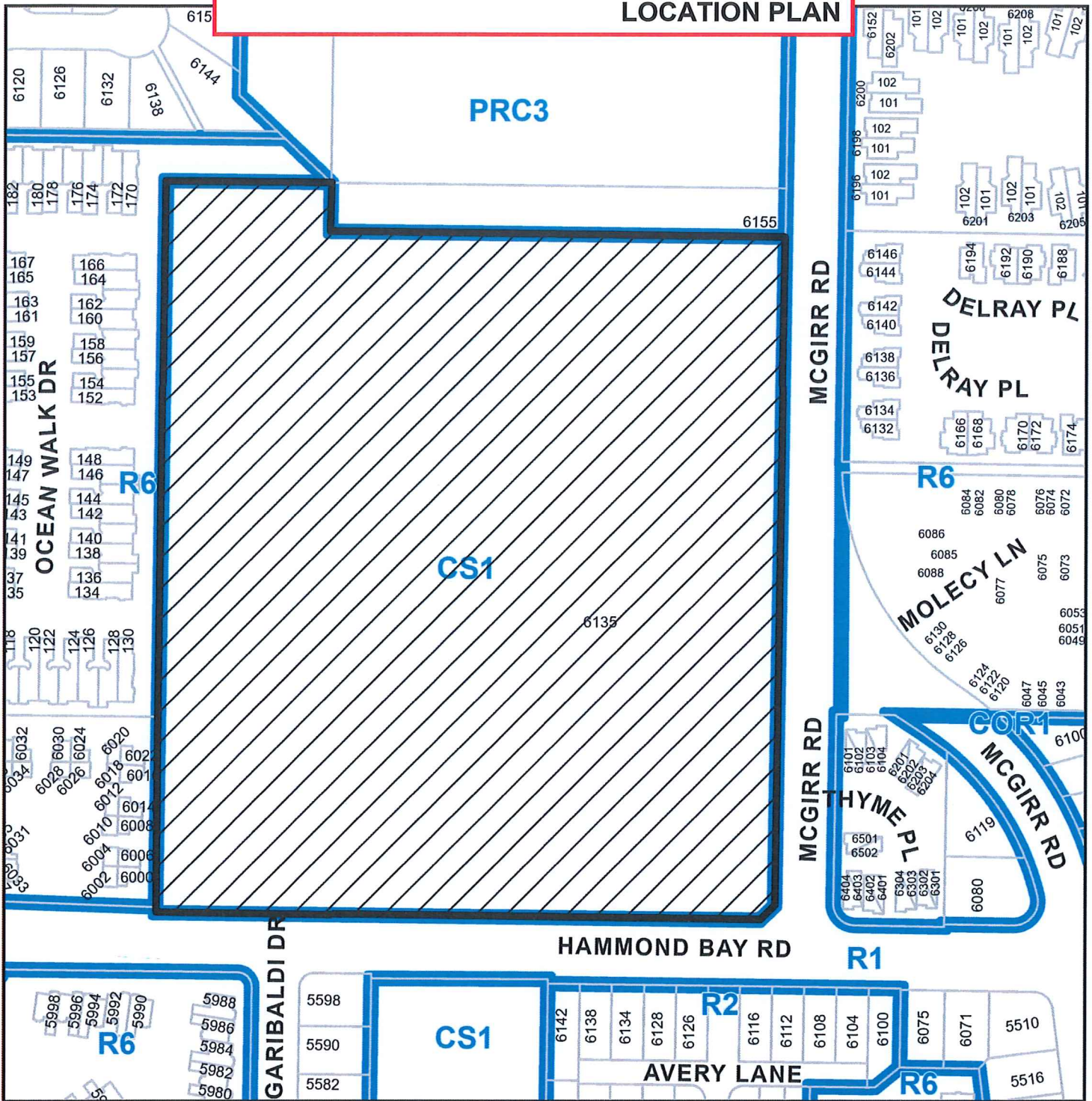
LOCATION PLAN



Subject Property

DEVELOPMENT VARIANCE PERMIT APPLICATION NO. DVP00434

CIVIC: 6135 MCGIRR ROAD

LEGAL: LOT A, DISTRICT LOT 48, WELLINGTON DISTRICT, PLAN VIP52017
 EXCEPT PART IN PLAN VIP68657

Development Variance Permit DVP00434 Schedule B
 6135 McGirr Road
SITE PLAN

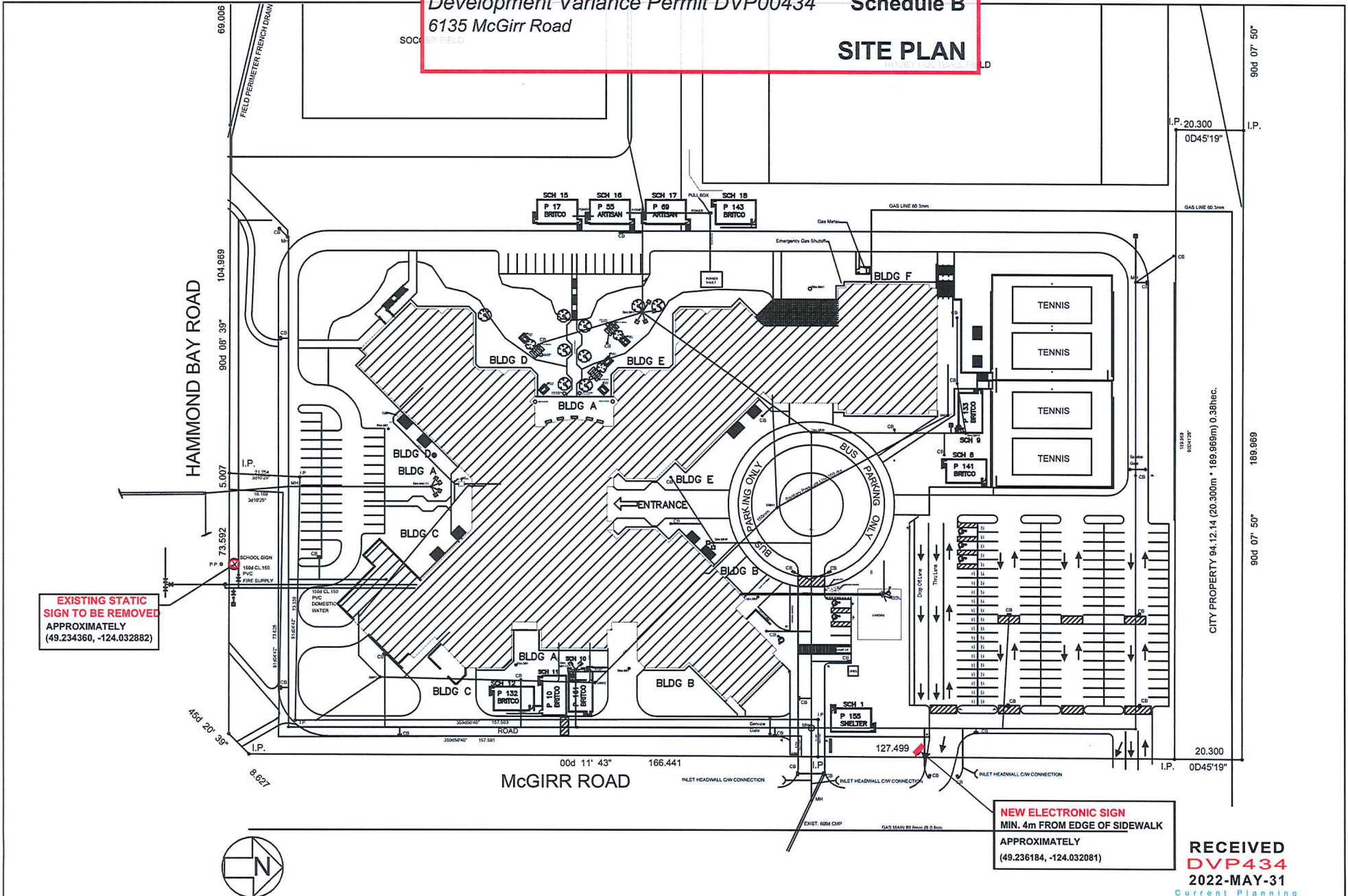

EXISTING STATIC SIGN TO BE REMOVED
 APPROXIMATELY
 (49.234360, -124.032882)

NEW ELECTRONIC SIGN
 MIN. 4m FROM EDGE OF SIDEWALK
 APPROXIMATELY
 (49.236184, -124.032081)

RECEIVED
DVP434
2022-MAY-31
 Current Planning



SCHOOL:	ADDRESS:	DRAWING TITLE:	DATE:	SHEET SIZE:	DESIGN BY:
DOVER BAY SECONDARY	6135 MCGIRR ROAD NANAIMO, BC V9V 1M1	SCHOOL SIGN	-	8.5 x 11	-
			SCALE:	SHEET #:	APPROVED BY:
			1:1500	1	-

SIGN DRAWINGS

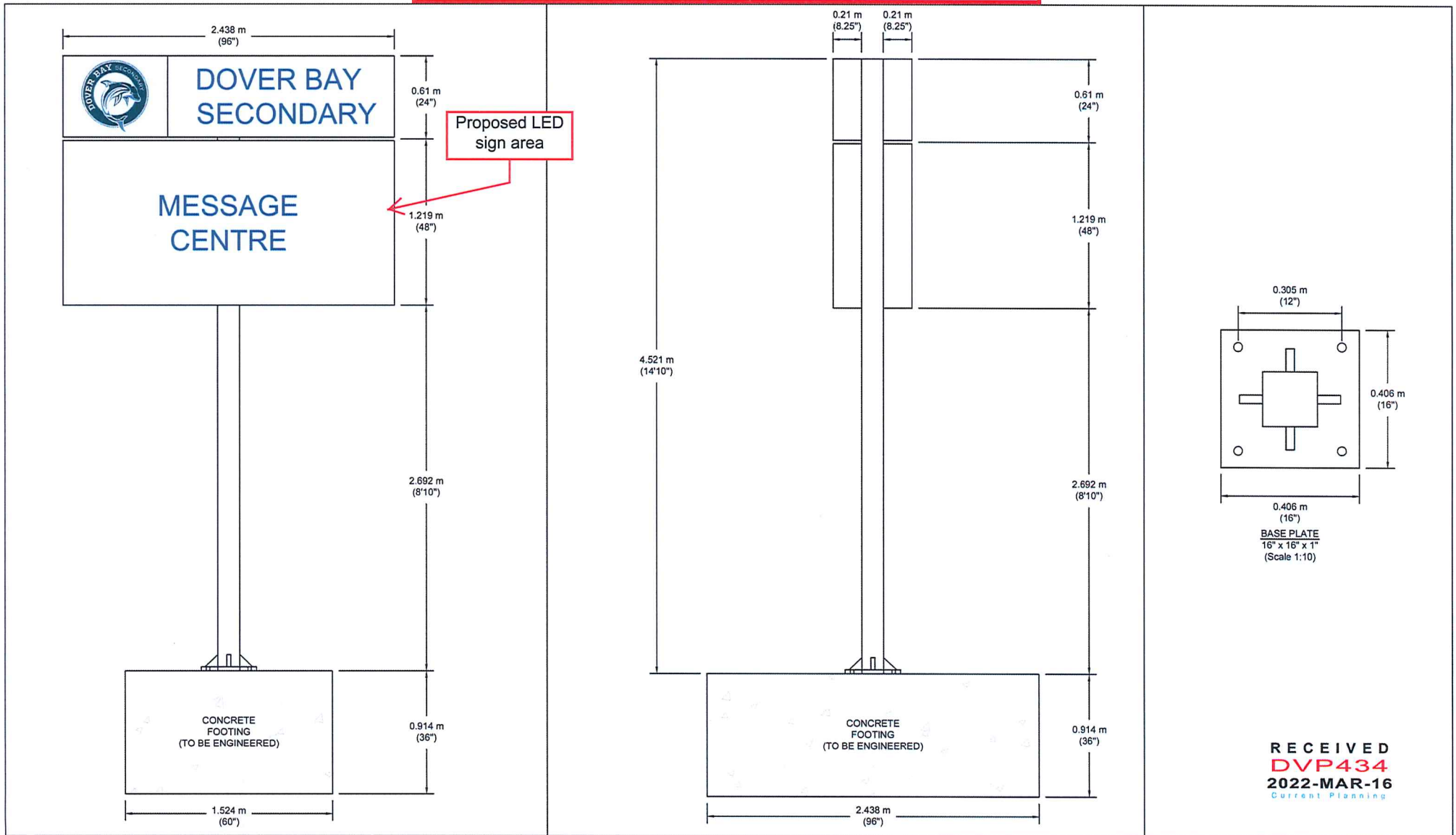

RECEIVED
DVP434
2022-MAR-16
Current Planning

<p>NANAIMO LADYSMITH PUBLIC SCHOOLS</p>	SCHOOL	ADDRESS	DRAWING TITLE	DATE:	SHEET SIZE:	DRAWN BY:	<p>NOTE: These drawings are the exclusive property of the Nanaimo Ladysmith Public Schools. These drawings are for Educational and / or Maintenance purposes of structures owned by them. Any questions or concerns should be directed to the Facilities Department for clarification. 250-741-5244</p>
	DOVER BAY SECONDARY	6135 MCGIRR ROAD NANAIMO, BC, V9V 1M1	SCHOOL SIGN	-	11 x 17	LG	
				SCALE:	SHEET#:	APPROVED BY:	
				1:25	1	-	

**LED / ANIMATED SIGNS - DEVELOPMENT VARIANCE
PERMIT GUIDELINES**

LED / ANIMATED SIGNS

Guidelines / Operational Requirements to be Considered as Part of the Development Variance Permit Application Process

The following are to be considered by applicants and used by staff and Council when evaluating DVP applications for LED / animated signs:

1. LED / animated signs that are only visible inside a building do not require a permit.
2. The maximum size of the LED / animated sign is 9.29m² (100ft²) and no more than one LED / animated sign shall be permitted per lot.
3. Window LED / animated signs are permitted up to 50 percent of the window area in which it is situated.
4. No LED / animated sign shall be permitted unless it can be demonstrated not to be a nuisance that distracts or impairs safe vehicle operation.
5. No LED / animated signs shall be permitted on properties fronting or adjacent to the Nanaimo Parkway.
6. Sign copy is limited to static images only which must be displayed for a minimum display period of six seconds per image. The use of animation effects to transition from one static image to the next will be permitted. Maximum transition time is three seconds. Continuous video, flashing or scrolling type signs are not permitted.
7. All LED / animated signs must include automatic dimming so that light intensity levels are automatically adjusted based on current weather conditions and the time of day.
8. The brightness level of all LED / animated signs shall not be more than 0.3 foot candles over ambient levels, as measured using a foot candle meter at a distance of 30m (98.42ft) from the face of the sign.
9. Where a residential dwelling is located within 30m (98.42ft) of the sign face, and for all LED / animated signs on lands zoned Institutional, the sign must be turned off between the hours of 10pm and 6am. Where the business is open past 10pm, the LED sign may remain functional until the close of business hours. An application should provide evidence to demonstrate no conflict will occur with any adjacent residential development.
10. Third-party advertising, except not-for-profit organizations or events, is not permitted except on LED / animated signs located on City-owned property. Third-party advertising for malls is permitted for tenants advertising on the subject property only.