

APPENDIX F

2017 DCC Bylaw - Water Supply Project List

					Allocated to Growth		Allocated to Existing Residents	
#	Project Name/Description	Location	Project Timing Range	Total Project Cost	Growth Percent	Growth Cost	Existing Percent	Existing Cost
1	DCC WSD1 Jump Creek II Dam	Jump Creek	2020/2027-2030	\$ 88,000,000	100%	\$ 88,000,000	0%	\$ -
3	DCC WS3 Extension Reservoir 9	Extension Reservoir 9	2027	\$ 3,300,000	100%	\$ 3,300,000	0%	\$ -
30	DCC WS 30 Labieux Road Pump Station Upgrade - install 2 additional pumps	Labieux Road Pump Station	2020	\$ 200,000	100%	\$ 200,000	0%	\$ -
36	DCC WS36 Vanderneuk Road Reservoir - new reservoir	Vanderneuk Road Reservoir	2029	\$ 5,100,000	100%	\$ 5,100,000	0%	\$ -
37	DCC WS 37 Uplands Drive Supply Main - new supply main for Vanderneuk Reservoir	Uplands Drive Supply Main (Rock City Rd to Vanderneuk Reservoir)	2028	\$ 8,900,000	100%	\$ 8,900,000	0%	\$ -
38	DCC WS 38 Water Treatment Plant - incremental cost from last DCC Review can be recovered in the current DCC Review.		2017-2041	\$ 12,000,000	30%	\$ 3,600,000	70%	\$ 8,400,000
39	DCC WS39 Boundary Ave/Island Hwy - increase current supply main capacity	Boundary Ave/Island Hwy Supply Main	2026	\$ 7,300,000	75%	\$ 5,475,000	25%	\$ 1,825,000
40	DCC WS 40 Nanaimo Lakes Road Supply Main - supply main replacement	Nanaimo Lakes Road Supply Main	2025	\$ 1,700,000	25%	\$ 425,000	75%	\$ 1,275,000
41	DCC WS 41 #1 Reservoir to College Park Supply Main - new main adjacent to current main	College Park Supply Main Duplication	2017	\$ 4,803,260	100%	\$ 4,803,260	0%	\$ -
NEW 42	DCC WS 42 Towers Reservoir - increase existing tank or construct 2nd tank	Towers Reservoir	2019	\$ 1,800,000	50%	\$ 900,000	50%	\$ 900,000
				\$ 133,103,260		\$ 120,703,260		\$ 12,400,000

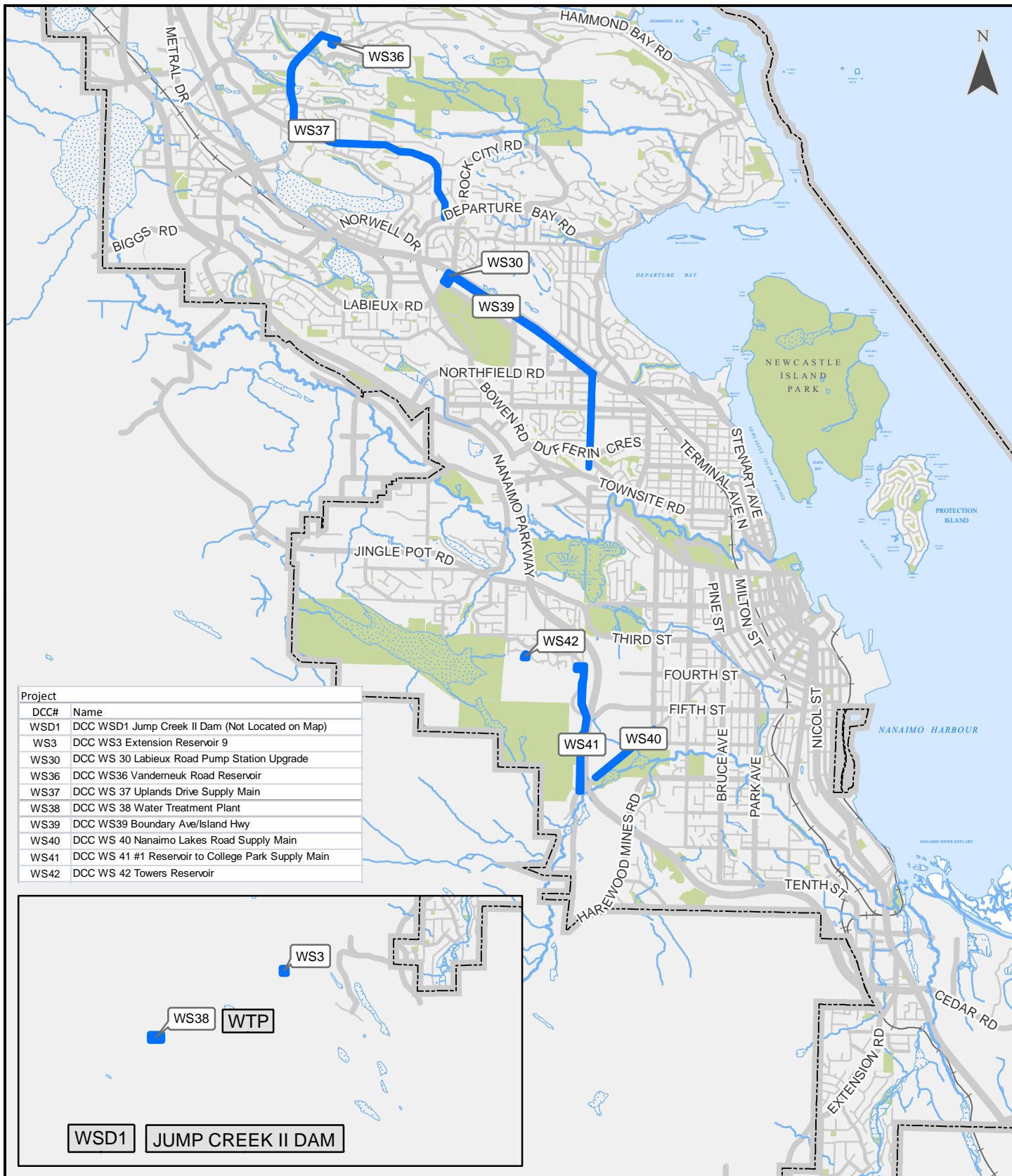

City of Nanaimo
2017
Water Supply DCC
Project Map

Legend

■ Water Supply DCC Project

Published: May 11, 2017
0 625 1,250 2,500
Meters
1:65,000



DISCLAIMER

This map is intended for general information only. The City of Nanaimo makes no representation or warranty regarding the accuracy or completeness of the information presented and assumes no responsibility for any damage, loss or injury resulting from the use of this product.

Engineering and Public Works Project Summary Sheet

DCC WSD-1 (100% Growth) Jump Creek II Dam - New Water Storage

Project:

Components:

	2030	Funding				
	Budget	General Taxation	DCC's	Water Reserves	Sewer Reserves	Other Sources
2361 DCC WSD-1 (100% Growth) Jump Creek II Dam - New Water Storage	88,000,000	0	88,000,000	0	0	0
	88,000,000	0	88,000,000	0	0	0

Project Description:

Development and construction of new water supply reservoir/dam, Jump Creek II Dam.

Asset Management Description of Work:

New - Not existing before

Justification:

Increase capacity to existing dam and reservoir at Jump Creek Dam. Provides for future growth and climate change adaptation.

DRAFT

Engineering and Public Works Project Summary Sheet

DCC WS3 : (100% Growth) Extension Reservoir 9A

Project:

Components:

610 DCC WS3 : (100% Growth) Extension Reservoir 9A

2027 Budget	Funding				
	General Taxation	DCC's	Water Reserves	Sewer Reserves	Other Sources
4,300,000	0	4,300,000	0	0	0
4,300,000	0	4,300,000	0	0	0

Project Description:

Construction of new 4900m³ concrete reservoir with TWL 198m
Includes piping from control building to new reservoir (increase of \$1M) *NEW

Asset Management Description of Work:

Upgrades - Increased service capacity

Justification:

This is required for capacity - for balancing storage and to provide fire flow

Project Map:

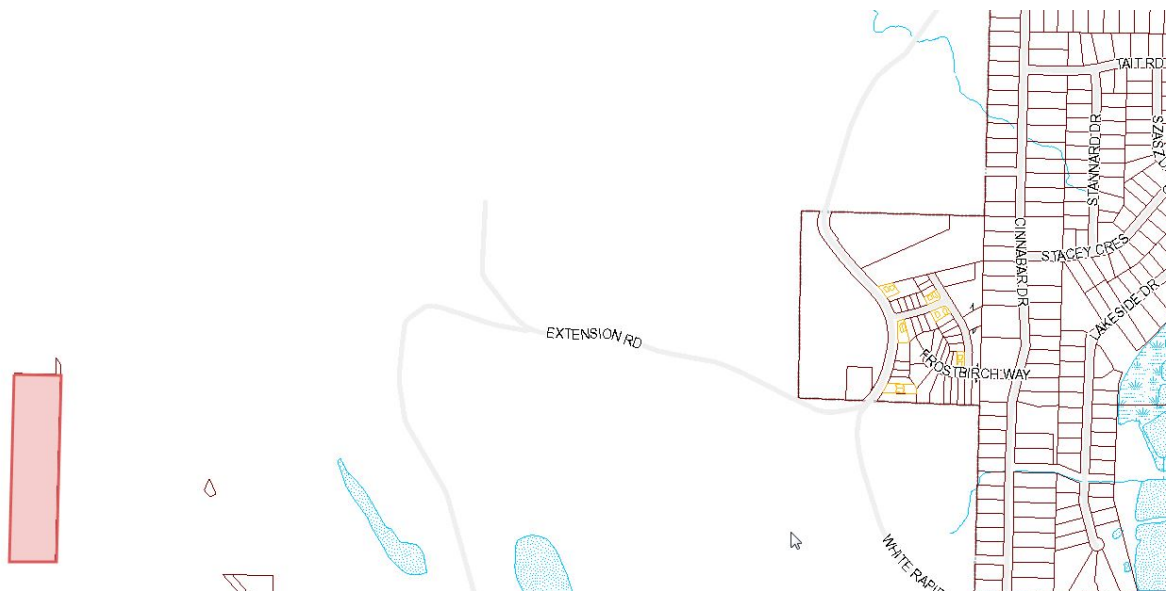

DRAFT

Engineering and Public Works Project Summary Sheet

DCC WS-30 (100% Growth) Labieux Booster PS Upgrades

Project:

Components:

2126 DCC WS-30 (100% Growth) Labieux Booster PS Upgrades

2020 Budget	Funding				
	General Taxation	DCC's	Water Reserves	Sewer Reserves	Other Sources
200,000	0	200,000	0	0	0
200,000	0	200,000	0	0	0

Project Description:

DCC Water Supply System -Upgrade Labieux booster pump station to meet increasing water demands.

Asset Management Description of Work:

Labieux Booster PS Upgrades

Justification:

Growth - Add two new pumps to support continued growth

Project Map:



DRAFT

Engineering and Public Works Project Summary Sheet

DCC WS36 : (100% Growth) Vanderneuk Reservoir

Project:

Components:

815 DCC WS36 :
Vanderneuk Reservoir

2029 Budget	Funding				
	General Taxation	DCC's	Water Reserves	Sewer Reserves	Other Sources
5,100,000	0	5,100,000	0	0	0
5,100,000	0	5,100,000	0	0	0

Project Description:

Construction of a new 2 million gallon (9230 m3) closed concrete or steel reservoir with a TWL of 170m

Asset Management Description of Work:

New reservoir

Justification:

Allows continued growth in north end, augments Lost Lake Reservoir No 2; supports fire flow.

Project Map:

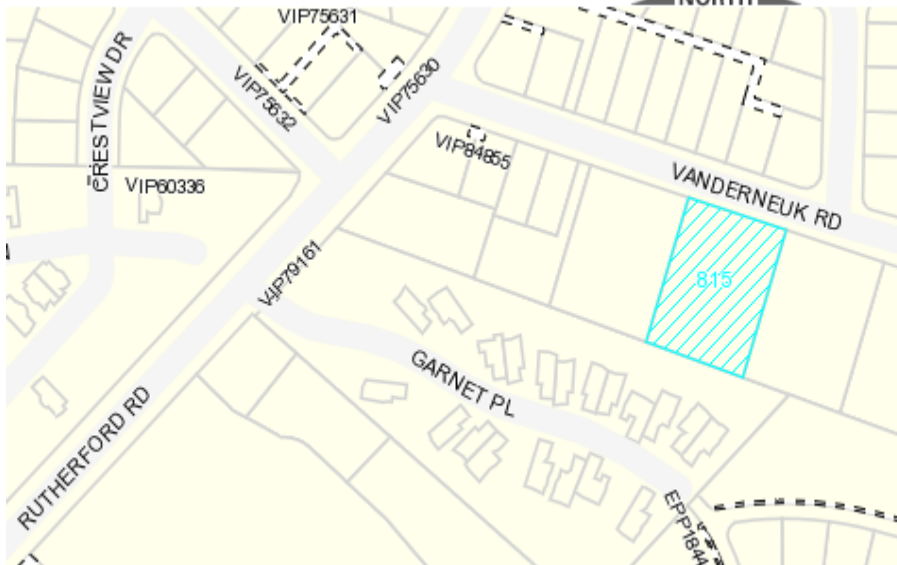

DRAFT

Engineering and Public Works Project Summary Sheet

DCC WS37 : (100% Growth) Uplands Drive Supply Main

Project:

Components:

	2028	Funding				
	Budget	General Taxation	DCC's	Water Reserves	Sewer Reserves	Other Sources
816 DCC WS37: (100% Growth) Uplands Drive Supply Main	8,900,000	0	8,900,000	0	0	0
	8,900,000	0	8,900,000	0	0	0

Project Description:

Uplands Drive Supply Main - Departure Bay Road to Vanderneuk Road to Turner

Asset Management Description of Work:

New - Not existing before

Justification:

Allows continued growth in north end, supplies Vanderneuk Reservoir; supports fire flow.

Project Map:



DRAFT

Engineering and Public Works Project Summary Sheet

DCC WS38 (30% Growth): Water Treatment Plant

Project:

Components:

	2014	Funding				
	Budget	General Taxation	DCC's	Water Reserves	Sewer Reserves	Other Sources
619 South Fork Water Treatment Plant	510,000	0	0	510,000	0	0
817 DCC WS38 : Water Treatment Plant	61,000,000	0	9,863,873	933,757	0	50,202,370
	61,510,000	0	9,863,873	1,443,757	0	50,202,370

Project Description:

Portion of Water Treatment Plant attributable to development (80,000-130,000)

Asset Management Description of Work:

New - Not existing before

Justification:

Regulatory requirement; protects drinking water quality for generations.



DRAFT

Engineering and Public Works Project Summary Sheet

DCC WS39 : (75% Growth) Boundary Ave / Island Hwy Supply Main

Project:

Components:

818 DCC WS39 : Boundary Ave /
Island Hwy Supply Main

2026 Budget	Funding				
	General Taxation	DCC's	Water Reserves	Sewer Reserves	Other Sources
7,300,000	0	5,475,000	1,825,000	0	0
7,300,000	0	5,475,000	1,825,000	0	0

Project Description:

Boundary Ave/Island Hwy Supply Main (Construction over 2 years 2025/2026)

Asset Management Description of Work:

Upgrades - Increased service capacity

Justification:

Augment capacity and provide duplication of Bowen Rd Supply main to provide for continued growth and fire flow.

Project Map:



DRAFT

Engineering and Public Works Project Summary Sheet

DCC WS40 : (25% Growth) Nanaimo Lakes Road Supply Main

Project:

Components:

	Budget	Funding				
		General Taxation	DCC's	Water Reserves	Sewer Reserves	Other Sources
819 DCC WS40 : (25% Growth) Nanaimo Lakes Road Supply Main	1,700,000	0	425,000	1,275,000	0	0
	1,700,000	0	425,000	1,275,000	0	0

Project Description:

Nanaimo Lakes Road Supply Main

Asset Management Description of Work:

Growth – Identified as a DCC Project

Justification:

Provides capacity for growth and fire protection in lower pressure zone

Project Map:

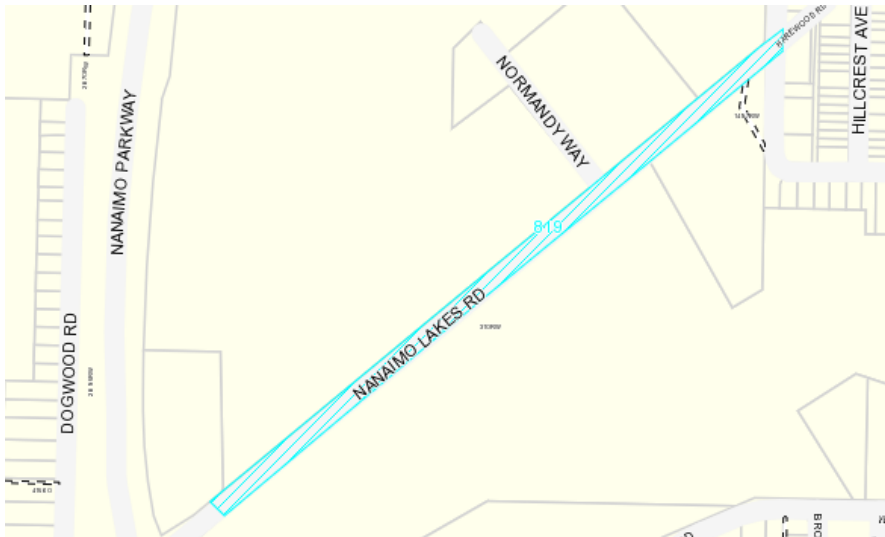

DRAFT

Engineering and Public Works Project Summary Sheet

DCC WS41: (100% Growth) #1 RES to College Pk Dup Supply WM & PRV

Project:

Components:

625 DCC WS41 (100% Growth): #1 RES to College Pk Dup Supply WM – New

2017 Budget	Funding				
	General Taxation	DCC's	Water Reserves	Sewer Reserves	Other Sources
4,360,000	0	4,360,000	0	0	0
4,360,000	0	4,360,000	0	0	0

Project Description:

Construction of a new water supply main, 1.6 km-750mm diameter steel, from Nanaimo Lakes Road to College Park Reservoirs.

The pipeline will increase the supply capacity and water system reliability to the City.

Asset Management Description of Work:

New – Not existing before

Justification:

This is required for capacity - to feed North end for growth. This also improves fire storage in existing reservoirs.

Project Map:



DRAFT

Engineering and Public Works Project Summary Sheet

DCC WS 42 – (50% Growth) Towers Reservoir

Project:

Components:

DCC WS42 (50% Growth):
Towers Reservoir

2019 Budget	Funding				
	General Taxation	DCC's	Water Reserves	Sewer Reserves	Other Sources
1,800,000	0	900,000	900,000	0	0
1,800,000	0	900,000	900,000	0	0

Project Description:

DCC WS42 (50% Growth): Towers Reservoir - Replacement

Asset Management Description of Work:

Replacement, Capacity Upgrade

Justification:

This is required for capacity – to feed West Nanaimo for balancing storage and to provide fire flow. Existing reservoir was undersized.

Project Map:



DRAFT