

APPENDIX A

2017 DCC Bylaw - Sewer Project List

DCC Project Number	Project Name	Location	Project Timing Range	Length (m)	Existing Diameter (mm)	Proposed Diameter (mm)	Total Project Cost	Allocated to Growth		Allocated to Existing	
								Growth Percent	Growth Cost	Existing Percent	Existing Cost
SS17	Millstone Trunk - North	Easement Jingle Pot Rd East to Int of Maxey & East Wellington	2017/2025	2,011.48	450/600	600/900	\$ 5,422,585	50%	\$ 2,711,294	50%	\$ 2,711,291
SS18	Millstone Trunk - Central	Millstone (East Wellington Rd to Westwood)	2022	1,056.68	600	900	\$ 1,659,128	85%	\$ 1,409,533	15%	\$ 249,595
SS19	Millstone Trunk - South	DCC SS19 Millstone Trunk/Buttertubs Upsizing	2019/2020	1,889.25	600	900	\$ 3,446,527	60%	\$ 2,067,917	40%	\$ 1,378,610
SS36	Metral Drive Area	Metral Drive Area	2025	291.00	NEW	350	\$ 449,397	100%	\$ 449,397	0%	\$ -
SS41	McGuffie & Keel Cove Area		2035	720.00	NEW	100/200	\$ 822,960	100%	\$ 822,960	0%	\$ -
SS44	Hammond Bay & Turner Area	Hammond Bay (Turner to Emil)	2023	851.59	200/250/375	300/375/450	\$ 1,414,072	100%	\$ 1,414,072	0%	\$ -
SS45	Chase River Pump Station & Forcemain	Eight St - Stirling to 441 Eighth, Island Hwy - 1169 Island Hwy to MH 6991 at Chase River PW,	2018/2019/2026, 10-20 years	1,723.35	500/675/900	350/1200	\$ 5,703,340	65%	\$ 3,723,585	35%	\$ 1,979,752
SS46	Richard Lake Trunk	RDN Chase River PS to Cedar Road	2019/10-20	1,157.09	375/450/525/600	525/600/675/750	\$ 2,297,426	100%	\$ 2,297,427	0%	\$ -
SS47	Doumont Rd & Parkway Area	Esmnt Dumont to 557 Doreen and Esmnt South of Parkway to Turnstone Pl	2022	270.09	200	300	\$ 349,722	90%	\$ 314,750	10%	\$ 34,972
SS48	Departure Bay Trunk	Departure Bay (Rock City to 2937 Bay) Rock City (Ocean Pearl to Dep	2028	3,194.02	150/200/250/300/350	300/375/450	\$ 4,561,739	96%	\$ 4,380,129	4%	\$ 181,609
SS49	Buttertubs Lateral	Buttertubs Lateral	2031	1,109.81	350	375/450	\$ 1,638,956	100%	\$ 1,638,956	0%	\$ -
SS52	Catchment Master Plans	Downtown South, Brechin, Departure Bay, Downtown North, Linley Valley, Wellington	2018-2041				\$ 2,133,600	30%	\$ 640,080	70%	\$ 1,493,520
SS53	Pine Street & Esmnt (Bruce to Albion)	Pine Street (321 Bruce adj to Chase River thru to Albion)	2026	667.95	300	450	\$ 1,046,244	100%	\$ 1,046,243	0%	-\$ 1
SS54	Seventh & Park Area	Seventh St (Siphon to Park Ave)	2018	115.46	375/400	600	\$ 406,400	80%	\$ 325,120	20%	\$ 81,280
SS55	Sixth St (Nanaimo Lakes to Bruce)		2018/2019/2020	933.21	200	300/375/450	\$ 1,318,098	97%	\$ 1,276,822	3%	\$ 41,274
SS56	Seventh & Brookfield Area	Brookfield Dr Esmnt, Seventh St, Howard Ave	2018/2021/2026	1,168.48	200	300	\$ 1,385,216	85%	\$ 1,180,175	15%	\$ 205,044
SS57	Bruce and Murray Area	Bruce and Murray Area	2019	347.45			\$ 152,400	100%	\$ 152,400	0%	\$ -
SS58	Long Lake Trunk	Ross (Bournemouth to Rock City)	2032	1,863.95	200/250/300	300/375	\$ 2,645,369	67%	\$ 1,759,232	33%	\$ 886,136
SS59	Nottingham to Stephenson Pnt Area	Hammond Bay to 605 Nottingham, 605 Nottingham to 3229 Hammond Bay, 3229	2021/2026/2031	1,129.09	200/250	300/375	\$ 1,094,629	100%	\$ 1,094,629	0%	\$ -
SS60	Big Bear (Noye to Godfrey)	Big Bear (Noye to Godfrey)	2032	227.02	200	300	\$ 322,922	80%	\$ 258,338	20%	\$ 64,584
SS61	Bradley & Mnt Benson Area	Bradley and Mount Benson	2017	396.87	250	300/375	\$ 509,797	90%	\$ 458,817	10%	\$ 50,980
SS62	Westdale (Westdale Esmnt to Hamm Bay)	Westdale (Westdale Esmnt to Hamm Bay)	2017	214.17	300	375	\$ 258,000	90%	\$ 232,200	10%	\$ 25,800
SS63	Fillinger Cr (5100 Fillinger to 5190 Fillinger)	Fillinger Cr (5100 Fillinger to 5190 Fillinger)	2018	346.01	150/250	375	\$ 1,473,200	20%	\$ 294,640	80%	\$ 1,178,560
SS64	Nova Esmnt Area	Seventh St (Georgia to Bruce)	2018	210.00			\$ 187,960	100%	\$ 187,960	0%	\$ -
SS7	Old Slope Area	Jingle Pot Road (at Old Slope Place)	2031	665.00	NEW	350	\$ 758,495	100%	\$ 758,495	0%	-\$ 0
							\$ 41,458,185		\$ 30,895,172		\$ 10,563,006

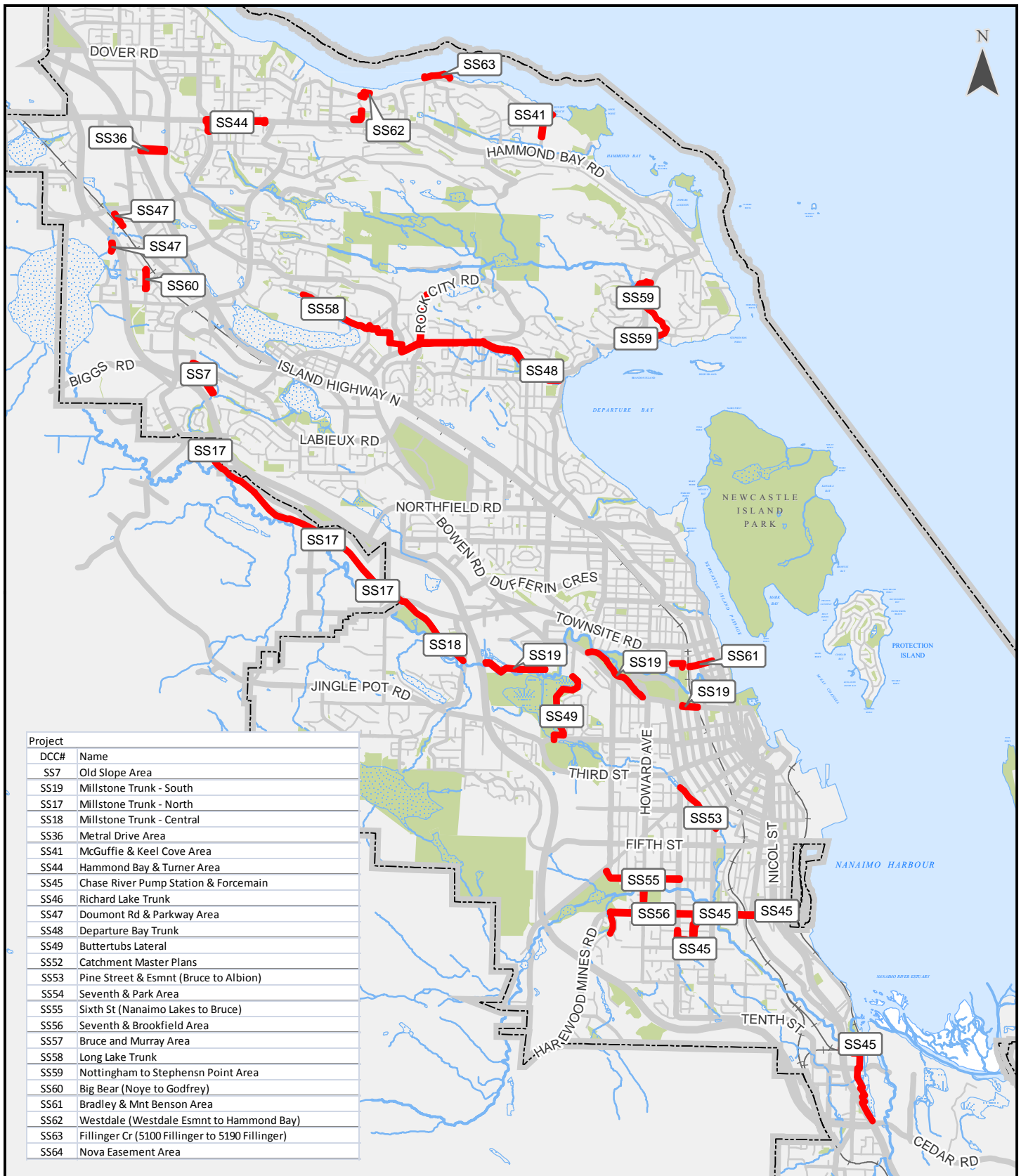

City of Nanaimo
2017
Sanitary DCC
Project Map

Legend

 Sanitary DCC Project

Published: May 9, 2017
0 625 1,250 2,500
Meters
1:65,000



DISCLAIMER

This map is intended for general information only. The City of Nanaimo makes no representation or warranty regarding the accuracy or completeness of the information presented and assumes no responsibility for any damage, loss or injury resulting from the use of this product.

Engineering and Public Works Project Summary Sheet

DCC SS7: (100% Growth) Jingle Pot Road SS (at Old Scope Pl)

Project:

Components:

821 DCC SS7: (100% Growth)
Jingle Pot Road SS (at Old Scope
Place)

2031	Funding				
Budget	General Taxation	DCC's	Water Reserves	Sewer Reserves	Other Sources
758,495	0	758,495	0	0	0
758,495	0	758,495	0	0	0

Project Description:

New 665m of 350mm diameter gravity mains to service Jingle Pot Road - at Old Slope Place

Asset Management Description of Work:

Growth - Identified as a DCC Project

Justification:

New 665m of 350mm diameter piping to service area as identified in the 2008 DCC Bylaw.

Project Map:



Engineering and Public Works Project Summary Sheet

Project:

DCC SS17: (50% Growth) Millstone Trunk SS (MH 2908 to East Wellington Road)

Components:

	2024	Funding				
	Budget	General Taxation	DCC's	Water Reserves	Sewer Reserves	Other Sources
823 DCC SS17: (50% Growth) Millstone Trunk SS (MH 2908 to East Wellington Road)	3,519,918	0	1,759,958	0	1,759,960	0
	3,519,918	0	1,759,958	0	1,759,960	0

Project Description:

Upsize 2km of 450mm to 600mm diameter on Maxey Road from MH 2908 to East Wellington.

Asset Management Description of Work:

Upgrades - Increased service capacity

Justification:

Pipe needed to be upsized from 1978 450mm to 600mm diameter due to current and future capacity shortfall identified in 2012 Millstone Sewer Trunk & Laterals Master Plan.

Project Map:



DRAFT

Engineering and Public Works Project Summary Sheet

Project:

DCC SS17: (50% Growth) Millstone Trunk SS (Jingle Pot North to MH 2908)

Components:

1663 DCC SS17: (50% Growth) Millstone Trunk SS (Jingle Pot North to MH 2908)

2017 Budget	Funding				
	General Taxation	DCC's	Water Reserves	Sewer Reserves	Other Sources
1,902,667	0	951,333	0	951,333	0
1,902,667	0	951,333	0	951,333	0

Project Description:

Project will upgrade 950 meters of existing 450 mm diameter asbestos cement sanitary sewer between Jingle Pot Road and Maxey Road to 600 mm diameter. As well, 180 meters of existing 600 mm diameter asbestos cement sanitary sewer will be upgraded to 750 mm diameter on Maxey Road near East Wellington Road.

Asset Management Description of Work:

Upgrades - Increased service capacity

Justification:

Pipe needed to be upsized from 1978 450mm to 600mm diameter due to current and future capacity shortfall identified in 2012 Millstone Sewer Trunk & Laterals Master Plan.

Project Map:



Engineering and Public Works Project Summary Sheet

DCC SS18: (85% Growth) Millstone Trunk SS (East Wellington to Westwood Road)

Project:

Components:

824 DCC SS18: (85% Growth)
Millstone Trunk SS (East
Wellington to Westwood Road)

2022 Budget	Funding				
	General Taxation	DCC's	Water Reserves	Sewer Reserves	Other Sources
1,659,128	0	1,409,533	0	249,595	0
1,659,128	0	1,409,533	0	249,595	0

Project Description:

Upsize ~1km of 600mm to 900mm diameter on Millstone Trunk between East Wellington and Westwood.

Asset Management Description of Work:

Upgrades - Increased service capacity

Justification:

Pipe needed to be upsized from 1977 600mm to 900mm diameter due to current and future capacity shortfall as identified in 2012 Millstone Sewer Trunk and Laterals Master Plan.

Project Map:



DRAFT

Engineering and Public Works Project Summary Sheet

DCC SS19: (60% Growth) Millstone Trunk South SS (Westwood Road to Pryde)

Project:

Components:

825 DCC SS19: (60% Growth)
Millstone Trunk South SS
(Westwood Road to Pryde)

2020 Budget	Funding				
	General Taxation	DCC's	Water Reserves	Sewer Reserves	Other Sources
1,416,186	0	849,712	0	566,475	0
1,416,186	0	849,712	0	566,475	0

Project Description:

Upsize 775m of 600mm to 900mm diameter on Millstone Trunk between Westwood and Pryde.

Asset Management Description of Work:

Upgrades - Increased service capacity

Justification:

Pipe needs to be upsized from 600mm to 900mm diameter due to existing capacity shortfalls and to service future growth as identified in 2012 Millstone Master Plan.

Project Map:

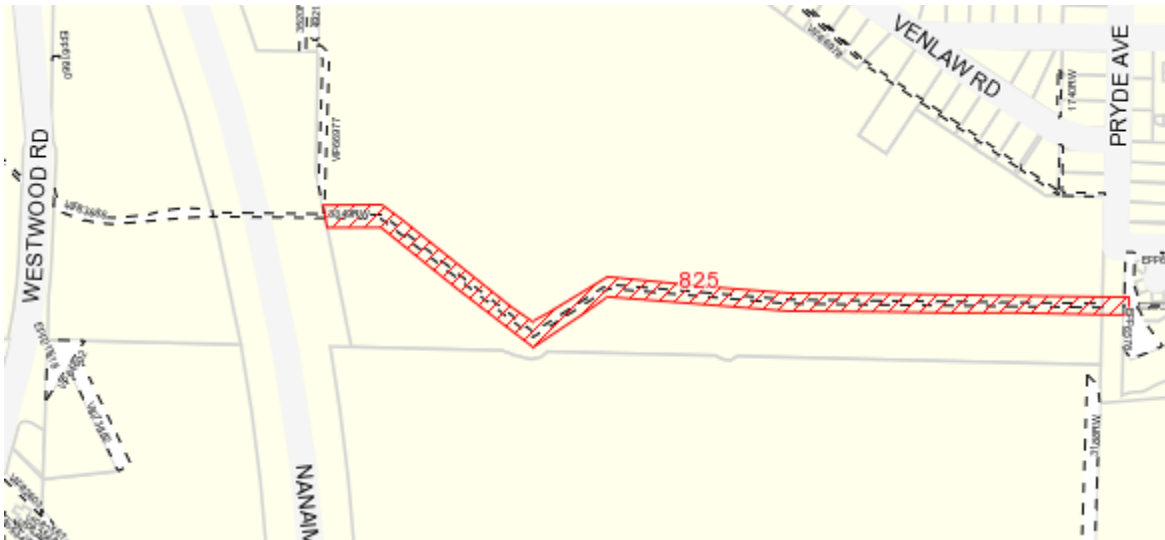

DRAFT

Engineering and Public Works Project Summary Sheet

DCC SS19: (60% Growth) Millstone Trunk South SS (within Bowen Park)

Project:

Components:

1558 DCC SS19 (60% Growth):
Millstone Trunk South SS (within
Bowen Park)

2019 Budget	Funding				
	General Taxation	DCC's	Water Reserves	Sewer Reserves	Other Sources
2,030,341	0	1,218,205	0	812,137	0
2,030,341	0	1,218,205	0	812,137	0

Project Description:

Upsize ~1.1km of 600mm to 900mm diameter on Millstone Trunk South within Bowen Park

Asset Management Description of Work:

Upgrades - Increased service capacity

Justification:

The pipe needs to be upsized from 600mm to 900mm diameter due to existing capacity shortfalls and to service future growth as identified in 2012 Millstone Master Plan.

Project Map:

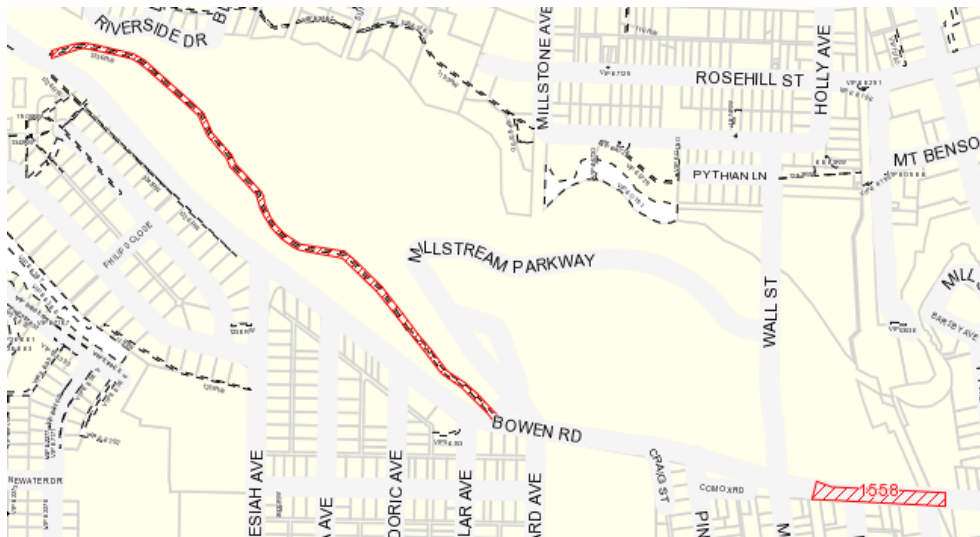

DRAFT

Engineering and Public Works Project Summary Sheet

DCC SS36: (100% Growth) Metral Drive Area SS

Project:

Components:

832 DCC SS36: (100% Growth) Metral Drive Area SS

2025 Budget	Funding				
	General Taxation	DCC's	Water Reserves	Sewer Reserves	Other Sources
450,000	0	450,000	0	0	0
450,000	0	450,000	0	0	0

Project Description:

New 290m of 350mm diameter gravity mains to service Metral Drive Area

Asset Management Description of Work:

Growth - Identified as a DCC Project

Justification:

New 290m of 350mm diameter piping to service area as identified in the 2008 DCC Bylaw.

Project Map:



DRAFT

Engineering and Public Works Project Summary Sheet

DCC SS41: (100% Growth) McGuffie Road area and Pumpstation SS

Project:

Components:

833 DCC SS41: (100% Growth)
McGuffie Road area and
Pumpstation SS

2035 Budget	Funding				
	General Taxation	DCC's	Water Reserves	Sewer Reserves	Other Sources
822,960	0	822,960	0	0	0
822,960	0	822,960	0	0	0

Project Description:

New 400m of 200mm diameter gravity mains, 320m of 100mm diameter forcemain and pump station to service McGuffie Road area

Asset Management Description of Work:

Growth - Identified as a DCC Project

Justification:

New piping and pump station to service area as identified in the 2008 DCC Bylaw.

Project Map:



DRAFT

Engineering and Public Works Project Summary Sheet

DCC SS44 - (100% Growth) Hammond Bay Road SS (Turner to Emil)

Project:

Components:

1482 DCC SS44 - (100% Growth)
Hammond Bay Road SS (Turner to
Emil)

2023 Budget	Funding				
	General Taxation	DCC's	Water Reserves	Sewer Reserves	Other Sources
1,414,072	0	1,414,072	0	0	0
1,414,072	0	1,414,072	0	0	0

Project Description:

Upsize 850m of 250mm/375mm to 375mm/450mm diameter on Hammond Bay Road from Turner to Emil

Asset Management Description of Work:

Upgrades - Increased service capacity

Justification:

Pipes need to be upsized from 200mm/250mm/375mm to 300mm/375mm/450mm diameter or regraded due to existing capacity shortfalls and to service future growth as identified in 2014 City Wide Sewer Model

Project Map:

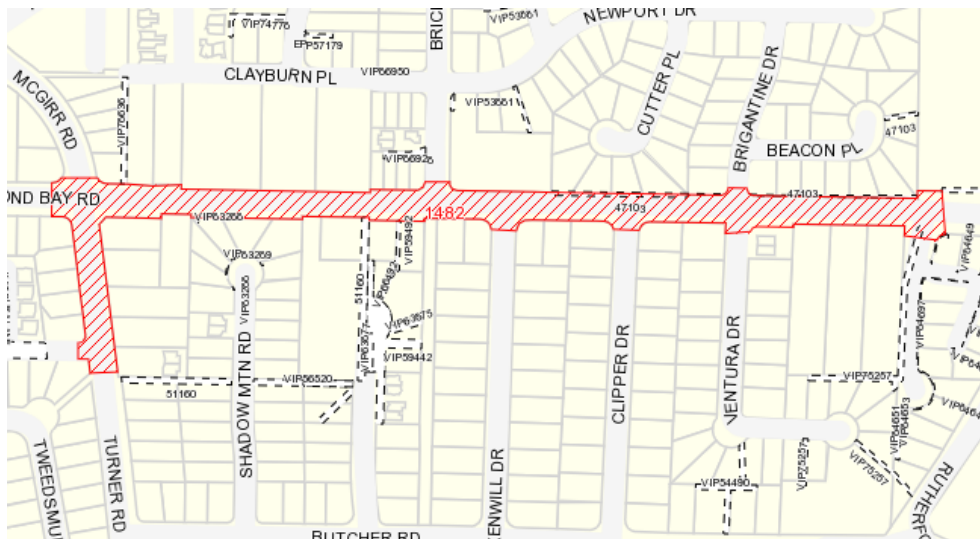

DRAFT

Engineering and Public Works Project Summary Sheet

Project: DCC SS45 (60% Growth) Seventh & Park SS PS - Stage 1

Components:

	2018	Funding				
	Budget	General Taxation	DCC's	Water Reserves	Sewer Reserves	Other Sources
1901 DCC SS45 (100% Growth)Seventh & Park SS PS - Stage 1	1,870,456	0	1,122,274	0	748,182	0
	1,870,456	0	1,122,274	0	748,182	0

Project Description:

New pump station to divert flows of 134 l/s when constructed in 2018 and up to 339 l/s in 2031 from the existing Chase River Trunk Main (directly East), and connecting to the regional interceptor.

Asset Management Description of Work:

Upgrades - Increased service capacity

Justification:

The Chase River Trunk Main was installed in the 1970's at an average depth of almost 6 meters, with some stretches exceeding 9m. This trunk is a vital sanitary conduit which is significantly under capacity during existing flow conditions and is demonstrating occasional surcharging which is contained within the system, for now. The City has completed a business case analysis to compare multiple options to expand the capacity of the trunk system. Ultimately a diversion pump station with forcemain was selected. Refer to 2014 Chaser River Master Plan.

Project Map:



Engineering and Public Works Project Summary Sheet

DCC SS45 (100% Growth) Eighth St SS PS- Upgrades Stage 2 (Seventh & Park)

Project:

Components:

1902 DCC SS45 (100% Growth) Eighth St SS PS- Upgrades Stage 2 (Seventh & Park)

2026 Budget	Funding				
	General Taxation	DCC's	Water Reserves	Sewer Reserves	Other Sources
309,880	0	309,880	0	0	0
309,880	0	309,880	0	0	0

Project Description:

The Chase River Pump Station will require a fourth pump, impeller upgrades, and the second kiosk installation.

Asset Management Description of Work:

Growth - Identified as a DCC Project

Justification:

When flows from the pump station (three pumps initially) exceed 165 L/s, redundancy is lost and this will trigger the impeller upgrade (2017 to 2022). When flows from the pump station exceed 235 L/s, redundancy is lost again and a fourth pump is required (likely beyond 2022). The Lift Station will require a fourth pump, impeller upgrades, and the second kiosk installation. Refer to 2014 Chase River Master Plan.

Project Map:

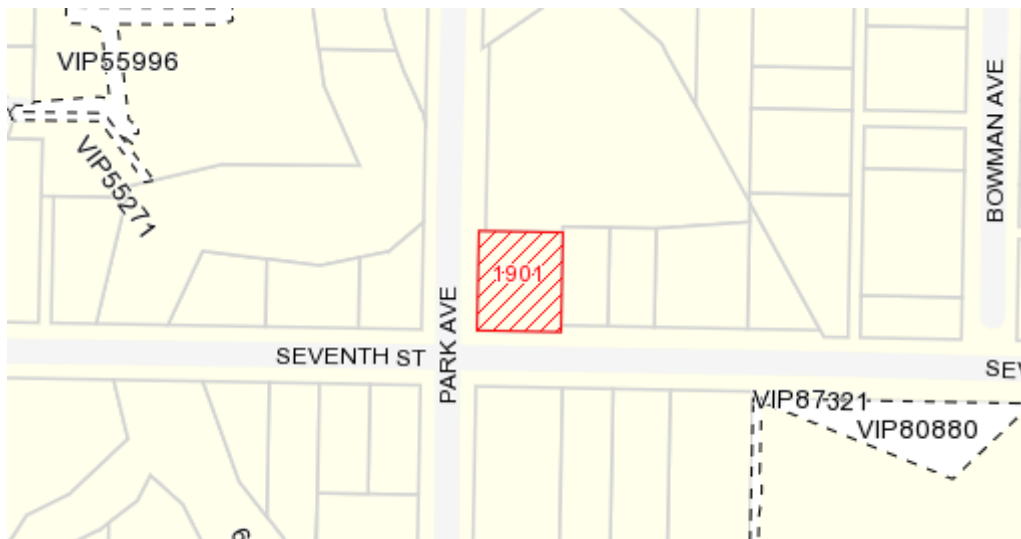

DRAFT

Engineering and Public Works Project Summary Sheet

Project: DCC SS45 (60% Growth) Seventh St SS FM - Stage 1

Components:

	2018 Funding				
	Budget	General Taxation	DCC's	Water Reserves	Sewer Reserves Other Sources
2034 DCC SS45 (60% Growth) Seventh St SS FM - Stage 1	2,716,784	0	1,630,070	0	1,086,714
	2,716,784	0	1,630,070	0	1,086,714

Project Description:

DCC Sanitary Sewer System - Construction new 1.6km of twinned forcemain on Seventh Street to connect from the Chase River pump station to the RDN interceptor

Asset Management Description of Work:

Upgrades - Increased service capacity

Justification:

The Chase River Trunk Main is significantly under capacity during existing flow conditions and is demonstrating occasional surcharging which is contained within the system, for now. The City has completed a business case analysis to compare multiple options to expand the capacity of the trunk system. Ultimately a diversion pump station with forcemain was selected. Refer to 2014 Chaser River Master Plan.

Project Map:

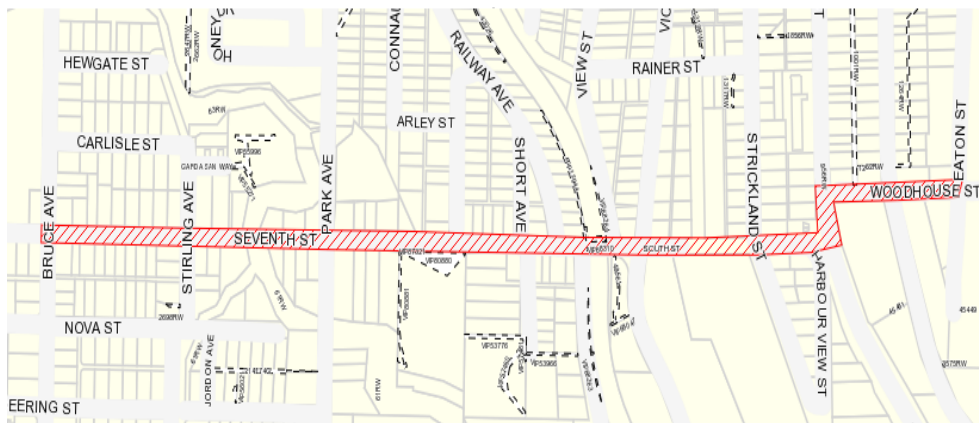

Engineering and Public Works Project Summary Sheet

DCC SS45 (30% Growth) Island Hwy SS (1169 Island Hwy to MH 6991 at Chase River PS)

Project:

Components:

	2019		Funding			
	Budget	General Taxation	DCC's	Water Reserves	Sewer Reserves	Other Sources
2359 DCC SS45 (30% Growth) Island Hwy SS (1169 Island Hwy to MH 6991 at Chase River PS)	101,600	0	30,480	0	71,120	0
	100,000	0	30,480	0	71,120	0

Project Description:

Upsize 40m of existing 500mm diameter DI across Island Hwy at 1169 to MH 6991 at Chase River PS.

Asset Management Description of Work:

Upgrades - Increased service capacity

Justification:

Pipe needs to be upsized due to existing capacity shortfalls and to service future growth as identified in 2014 Chase River Master Plan.

Project Map:



DRAFT

Engineering and Public Works Project Summary Sheet

DCC SS45 Assets North of Eighth St - Stage 2 Chase River PS

Project:

Components:

2363 DCC SS45 Assets
North of Eighth St - Stage 2
Chase River PS

2027 Budget	Funding				
	General Taxation	DCC's	Water Reserves	Sewer Reserves	Other Sources
458,833	0	458,833	0	0	0
458,833	0	458,833	0	0	0

Project Description:

Upsize ~190m of 900mm to 1200mm diameter on Stirling Ave from Nova to Murray

Asset Management Description of Work:

Upgrades - Increased service capacity

Justification:

Pipe needs to be upsized from 900mm to 1200mm diameter due to existing capacity shortfalls and to service future growth as identified in 2014 Chase River Master Plan.

Project Map:



DRAFT

Engineering and Public Works Project Summary Sheet

DCC SS45: (70% Growth) Eighth St SS Pipe #513731

Project:

Components:

2159 DCC SS45: (70% Growth) Eighth St SS Pipe #513731

2018 Budget	Funding				
	General Taxation	DCC's	Water Reserves	Sewer Reserves	Other Sources
245,788	0	172,051	0	73,736	0
245,788	0	172,051	0	73,736	0

Project Description:

Upsize ~95m of 675mm to 1200mm diameter Pipe #513731 on Eighth Street

Asset Management Description of Work:

Upgrades - Increased service capacity

Justification:

Pipe needs to be upsized from 675mm to 1200mm diameter due to existing capacity shortfalls and to service future growth as identified in 2014 Chase River Master Plan.

Project Map:

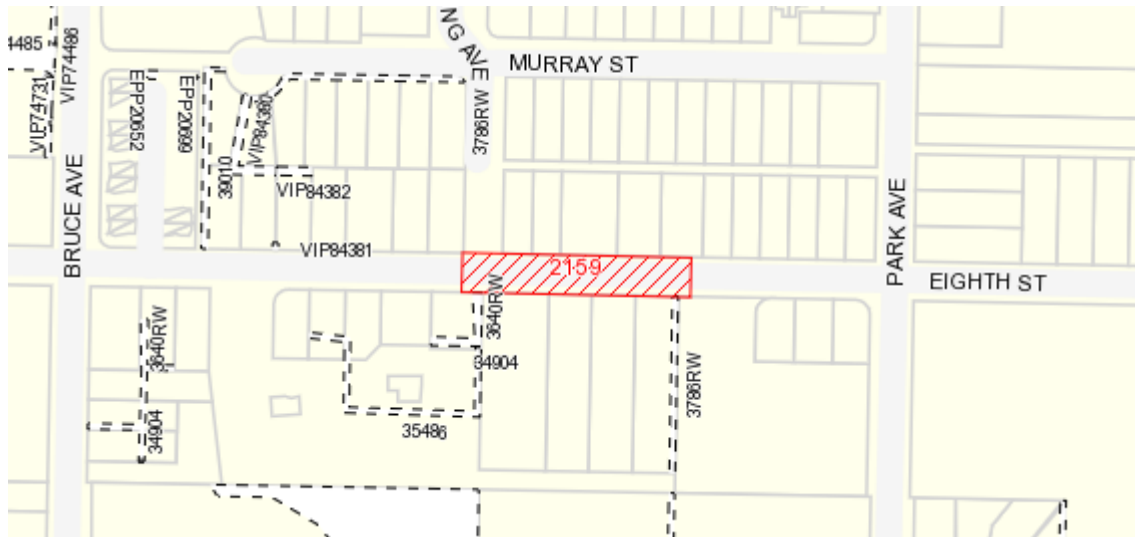

DRAFT

Engineering and Public Works Project Summary Sheet

DCC SS46: (100% Growth) Isl Hwy Esmnt 37125 SS (MH 6955 40 Maki to MH 6971 1336 Isl Hwy)

Project:

Components:

1490 DCC SS46: (100% Growth)
Isl Hwy Esmnt 37125 SS (MH 6955
40 Maki to MH 6971 1336 Isl Hwy)

2030 Budget	Funding				
	General Taxation	DCC's	Water Reserves	Sewer Reserves	Other Sources
1,007,150	0	1,007,150	0	0	0
1,007,150	0	1,007,150	0	0	0

Project Description:

Upsize 475m of Sanitary Sewer on Island Hwy Esmnt 37125 from MH 6955 at 40 Maki to MH 6971 at 1336 Isl Hwy

Asset Management Description of Work:

Upgrades - Increased service capacity

Justification:

The pipe needs to be upsized from 450mm/525mm/600mm to 600mm/675mm/750mm diameter due to existing capacity shortfalls and to service future growth as identified in 2014 Chase River Master Plan.

Project Map:



DRAFT

Engineering and Public Works Project Summary Sheet

DCC SS46 (100% Growth) Isl Hwy Esmnt 40546 (MH 6955 40 Maki to Chase River PS)

Project:

Components:

2282 DCC SS46 (100% Growth) Isl Hwy Esmnt 40546 (MH 6955 40 Maki to Chase River PS)

2019 Budget	Funding				
	General Taxation	DCC's	Water Reserves	Sewer Reserves	Other Sources
457,200	0	457,200	0	0	0
457,200	0	457,200	0	0	0

Project Description:

Upsize ~200m of 600mm to 750mm diameter on Island Hwy Esmt 40546 from MH 6955 at 40 Maki to Chase River PS

Asset Management Description of Work:

Upgrades - Increased service capacity

Justification:

Pipe needs to be upsized from 600mm to 750mm diameter due to existing capacity shortfalls and to service future growth as identified in 2014 Chase River Master Plan.

Project Map:



DRAFT

Engineering and Public Works Project Summary Sheet

DCC SS46 (100% Growth) Isl Hwy Esmnt 37125 SS (MH 6971 1336 Isl Hwy to Cedar Rd)

Project:

Components:

1906 DCC SS46 (100% Growth) Isl Hwy Esmnt 37125 SS (MH 6971 1336 Isl Hwy to Cedar Rd)

2030 Budget	Funding				
	General Taxation	DCC's	Water Reserves	Sewer Reserves	Other Sources
859,360	0	859,360	0	0	0
859,360	0	859,360	0	0	0

Project Description:

Upsize ~480m of 375mm to 525mm diameter on Island Hwy Esmt 37125 from MH 6971 at 1336 Isl Hwy to Cedar Rd

Asset Management Description of Work:

Upgrades - Increased service capacity

Justification:

Pipe needs to be upsized from 375mm to 525mm diameter due to existing capacity shortfalls and to service future growth as identified in 2014 Chase River Master Plan.

Project Map:



DRAFT

Engineering and Public Works Project Summary Sheet

DCC SS47: (90% Growth) Millstone Lateral SS - (Easement off Doumont to 557 Doreen)

Project:

Components:

	2022	Funding				
	Budget	General Taxation	DCC's	Water Reserves	Sewer Reserves	Other Sources
837 DCC SS47: (90% Growth) Millstone Lateral SS - (Easement off Doumont to 557 Doreen)	265,295	0	238,765	0	26,529	0
	265,295	0	238,765	0	26,529	0

Project Description:

Upsize pipes from 200m to 300mm diameter on Millstone Lateral in easement off Doumont to 557 Doreen.

Asset Management Description of Work:

Upgrades – increased service capacity

Justification:

Pipe needs to be upsized from 200mm to 300mm diameter due to existing capacity shortfalls and to service future growth as identified in 2012 Millstone Master Plan.

Project Map:

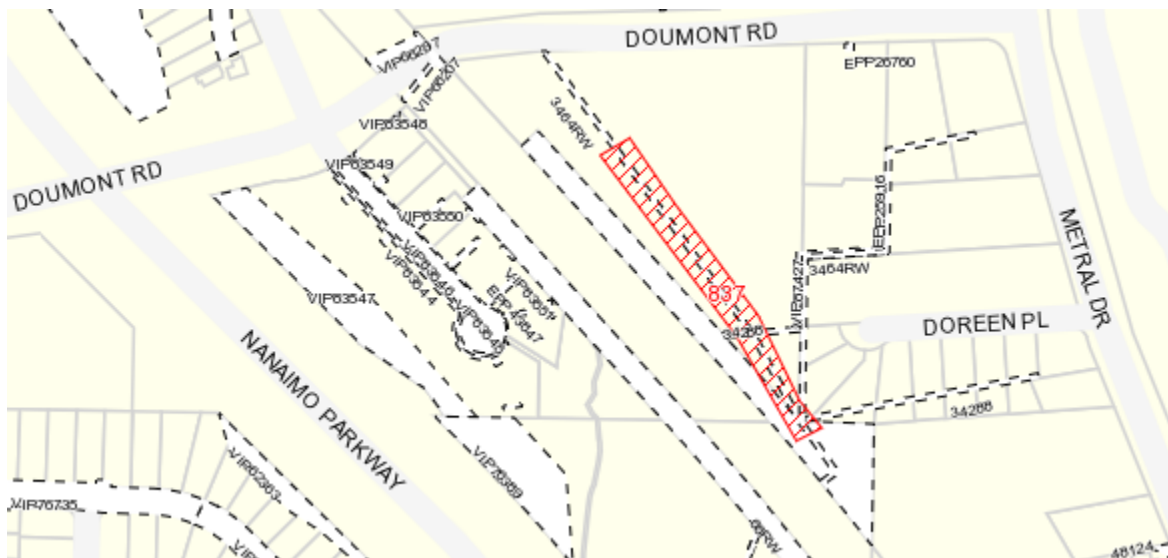

DRAFT

Engineering and Public Works Project Summary Sheet

DCC SS47: (90% Growth) Millstone Lateral SS (Easement South of Parkway to Turnstone PI)

Project:

Components:

1775 DCC SS47: (90% Growth) Millstone Lateral SS (Easement South of Parkway to Turnstone PI)

2022 Budget	Funding				
	General Taxation	DCC's	Water Reserves	Sewer Reserves	Other Sources
84,428	0	75,985	0	8,443	0
84,428	0	75,985	0	8,443	0

Project Description:

Upsize ~100m of 200mm to 300mm diameter in Esmt South of Parkway to Turnstone PI

Asset Management Description of Work:

Upgrades - Increased service capacity

Justification:

Pipe needs to be upsized from 200mm to 300mm diameter due to existing capacity shortfalls and to service future growth as identified in 2012 Millstone Master Plan.

Project Map:



DRAFT

Engineering and Public Works Project Summary Sheet

DCC SS48: (96% Growth) Departure Bay Trunk SS

Project:

Components:

838 DCC SS48: (96% Growth) Departure Bay Trunk SS

2028 Budget	Funding				
	General Taxation	DCC's	Water Reserves	Sewer Reserves	Other Sources
4,561,739	0	4,380,129	0	181,609	0
4,561,739	0	4,380,129	0	181,609	0

Project Description:

Upsize 2.6km of sanitary sewer on Departure Bay Road from Rock City to Bay and upsize 585m of sanitary sewer on Rock City Road from Dep Bay to Opal

Asset Management Description of Work:

Upgrades – increased service capacity

Justification:

Pipe needs to be upsized from 150mm/200mm/250mm/300mm/350mm to 300mm/375mm/450mm diameter due to existing capacity shortfalls and to service future growth as identified in 2014 City Wide Sewer Model.

Project Map:



DRAFT

Engineering and Public Works Project Summary Sheet

DCC SS49: (100% Growth) Buttertubs Lateral - Diversion SS

Project:

Components:

839 DCC SS49: (100% Growth)
Buttertubs Lateral - Diversion SS

2041 Budget	Funding				
	General Taxation	DCC's	Water Reserves	Sewer Reserves	Other Sources
1,638,956	0	1,638,956	0	0	0
1,638,956	0	1,638,956	0	0	0

Project Description:

Upsize 1.1km of 350mm to 450mm diameter along Buttertubs Marsh from Jingle Pot to Buttertubs

Asset Management Description of Work:

Growth - Identified as a DCC Project

Justification:

Pipe needs to be upsized from 350mm to 450mm diameter to service future growth as identified in 2012 Millstone Master Plan.

Project Map:



DRAFT

Engineering and Public Works Project Summary Sheet

DCC SS53: (100% Growth) Pine Street SS (321 Bruce adj to Chase River thru to Albion)

Project:

Components:

1856 DCC SS53: (100% Growth) Pine Street SS (321 Bruce adj to Chase River thru to Albion)

2026 Budget	Funding				
	General Taxation	DCC's	Water Reserves	Sewer Reserves	Other Sources
1,050,000	0	1,050,000	0	0	0
1,050,000	0	1,050,000	0	0	0

Project Description:

Upsize ~670m of 300mm to 450mm diameter on Pine Street from 321 Bruce adjacent to Chase River thru to Albion

Asset Management Description of Work:

Growth - Identified as a DCC Project

Justification:

Pipe needs to be upsized from 300mm to 450mm diameter to service future growth as identified in 2014 Chase River Master Plan.

Project Map:

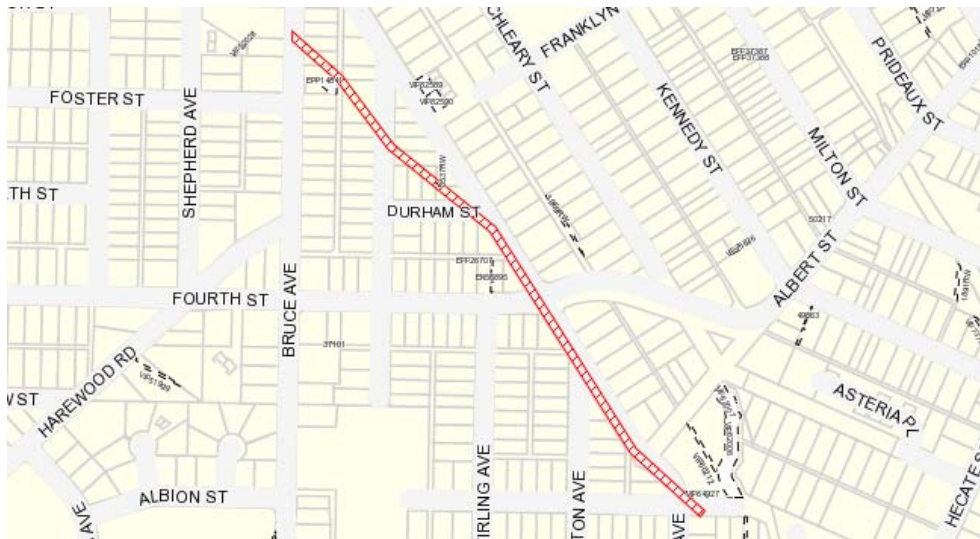

DRAFT

Engineering and Public Works Project Summary Sheet

DCC SS54: (80% Growth) Seventh Street SS (Siphon to Park Ave)

Project:

Components:

1873 DCC SS54: (80% Growth) Seventh St SS (Siphon to Park Ave)

2018 Budget	Funding				
	General Taxation	DCC's	Water Reserves	Sewer Reserves	Other Sources
406,400	0	325,120	0	81,280	0
406,400	0	325,120		81,280	0

Project Description:

Upsize 115m of 375mm/400mm to 600mm diameter on Seventh Street from siphon to Park

Asset Management Description of Work:

Upgrades - Increased service capacity

Justification:

Upsize siphon from 375mm/400mm to 600mm diameter due to existing capacity shortfalls and to service future growth as identified in 2014 Chase River Sewer Master Plan.

Project Map:

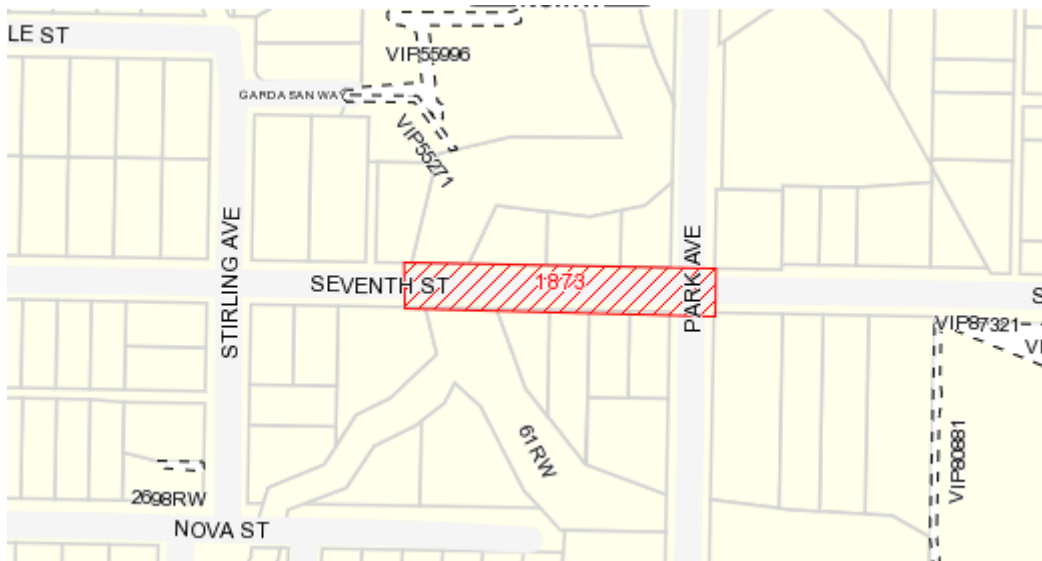

DRAFT

Engineering and Public Works Project Summary Sheet

DCC SS55: (100% Growth) Sixth St SS (Nanaimo Lakes Road to Howard) - PH 3

Project:

Components:

1869 DCC SS55: (100% Growth) Sixth St SS (Nanaimo Lakes Road to Howard) - PH 3

2020 Budget	Funding				
	General Taxation	DCC's	Water Reserves	Sewer Reserves	Other Sources
682,903	0	682,903	0	0	0
682,903	0	682,903	0	0	0

Project Description:

Upsize ~510m of 200mm to 300mm/375mm diameter on Sixth Street from Nanaimo Lakes to Howard - Ph 3

Asset Management Description of Work:

Growth - Identified as a DCC Project

Justification:

Pipe needs to be upsized from 200mm to 300mm diameter to service future growth as identified in 2014 Chase River Master Plan.

Project Map:

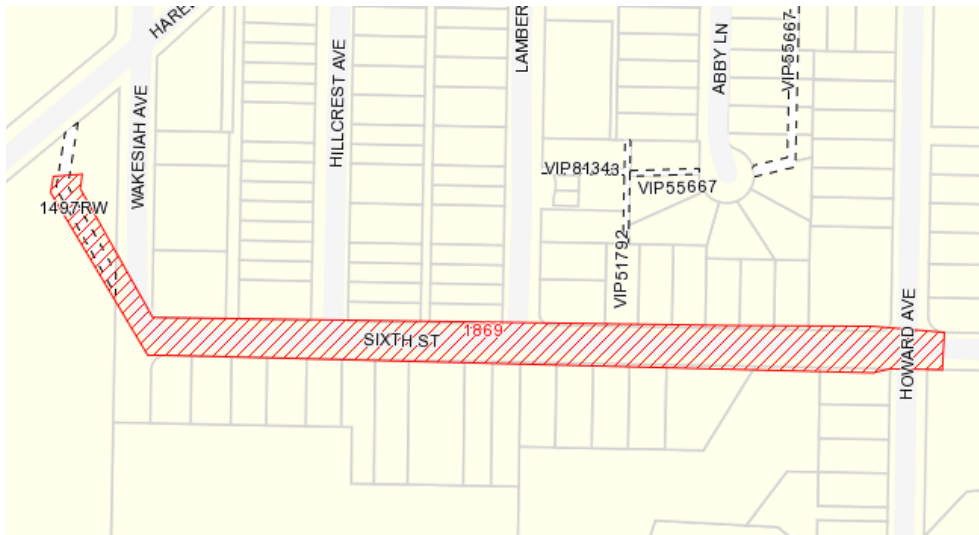

DRAFT

Engineering and Public Works Project Summary Sheet

DCC SS55: (90% Growth) Sixth St SS (Bruce to Georgia) - PH 1

Project:

Components:

1406 DCC SS55: (90% Growth) Sixth St SS (Bruce to Georgia) - PH 1

2018 Budget	Funding				
	General Taxation	DCC's	Water Reserves	Sewer Reserves	Other Sources
338,118	0	304,305	0	33,813	0
338,118		304,305		33,813	0

Project Description:

Upsize 225m of 200mm to 375/450mm diameter on Sixth Street from Bruce to Georgia - Ph 1

Asset Management Description of Work:

Upgrades - Increased service capacity

Justification:

Pipes need to be upsized from 200mm to 375mm/450mm diameter due to existing capacity shortfalls and to service future growth as identified in 2014 Chase River Sanitary Master Plan.

Project Map:

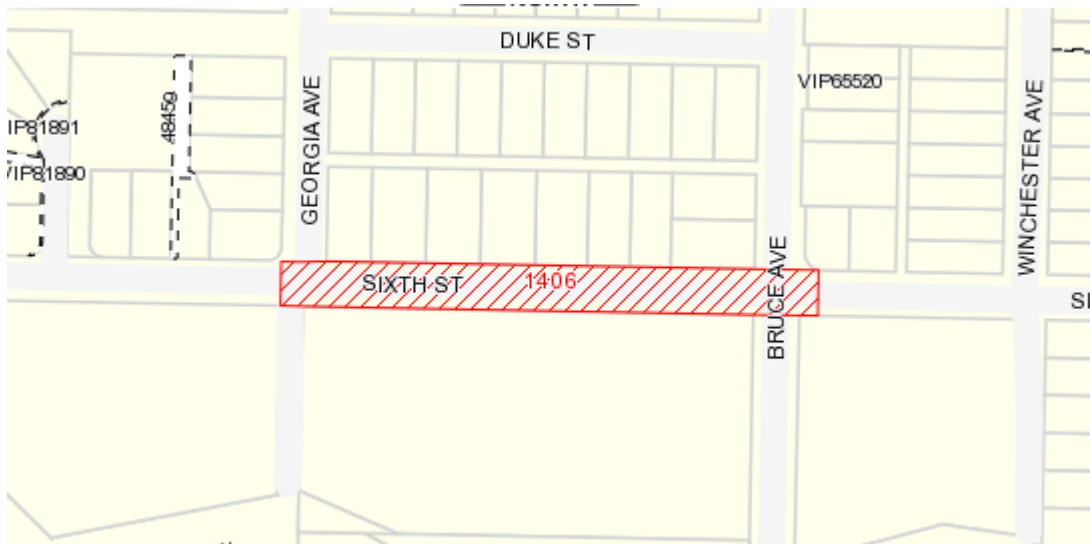

DRAFT

Engineering and Public Works Project Summary Sheet

DCC SS55: (100% Growth) Sixth St SS (Georgia to Howard) - PH2

Project:

Components:

2060 DCC SS55: (100% Growth) Sixth St SS (Georgia to Howard) - PH2

2019 Budget	Funding				
	General Taxation	DCC's	Water Reserves	Sewer Reserves	Other Sources
297,077	0	297,077	0	0	0
297,077	0	297,077	0	0	0

Project Description:

Upsize ~200m of 200mm to 375mm diameter on Sixth Street from Georgia to Howard - Ph 2

Asset Management Description of Work:

Upgrades - Increased service capacity

Justification:

Pipe needs to be upsized from 200mm to 375mm diameter due to existing capacity shortfalls and to service future growth as identified in 2014 Chase River Master Plan.

Project Map:

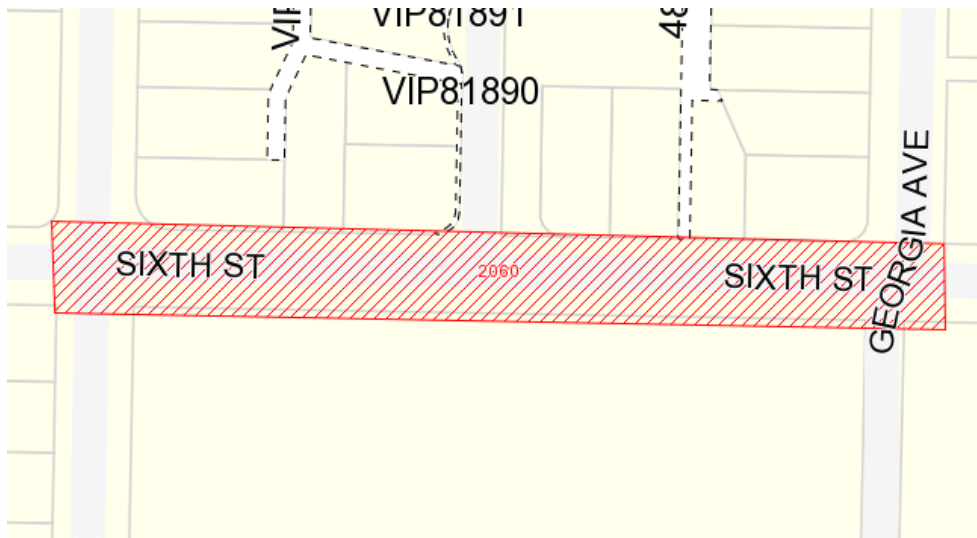

DRAFT

Engineering and Public Works Project Summary Sheet

DCC SS56: (93% Growth) Seventh St SS (621 Seventh to Georgia Ave) - Ph 3

Project:

Components:

1851 DCC SS56: (93% Growth) Seventh St SS (621 Seventh to Georgia Ave) - Ph 3

2026 Budget	Funding				
	General Taxation	DCC's	Water Reserves	Sewer Reserves	Other Sources
532,195	0	532,195	0	0	0
532,195	0	532,195	0	0	0

Project Description:

Upsize ~400m of 200m to 300mm diameter on Seventh Street from 621 Seventh to Georgia - Ph 3

Asset Management Description of Work:

Growth - Identified as a DCC Project

Justification:

Pipe needs to be upsized from 200mm to 300mm diameter to service future growth as identified in 2014 Chase River Master Plan.

Project Map:

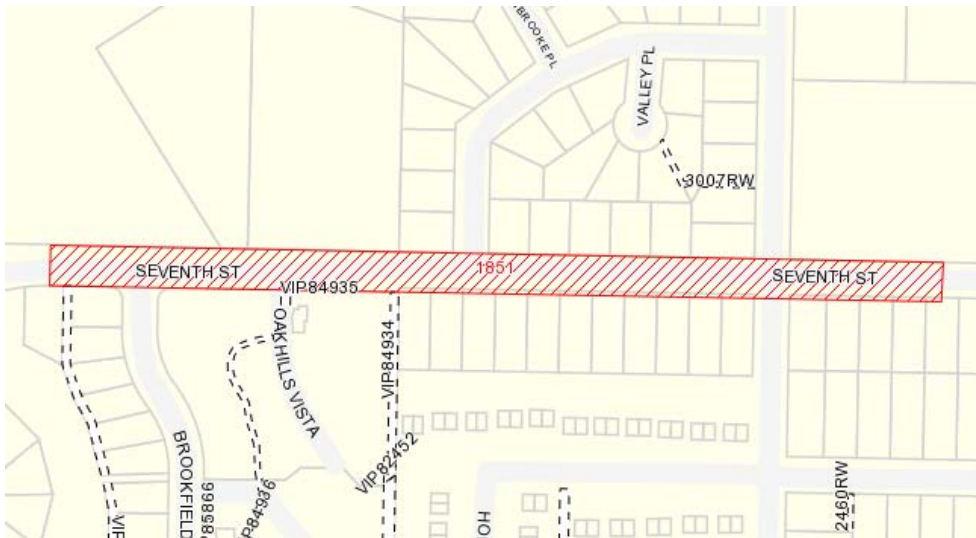

DRAFT

Engineering and Public Works Project Summary Sheet

DCC SS56: (~70% Growth) Howard Ave SS (Seventh to Brookside) - Ph 2

Project:

Components:

1872 DCC SS56: (100% Growth) Howard Ave SS (Seventh to Brookside) - Ph 2

2021 Budget	Funding				
	General Taxation	DCC's	Water Reserves	Sewer Reserves	Other Sources
388,286	0	273,815	0	114,471	0
388,286	0	273,815	0	114,471	0

Project Description:

Upsize ~ 290m of 200mm to 300mm diameter on Howard Ave from Seventh to Brookside - Ph 2

Asset Management Description of Work:

Upgrades - Increased service capacity

Justification:

Pipe needs to be upsized from 200mm to 300mm diameter due to existing capacity shortfalls and to service future growth as identified in 2014 Chase River Master Plan.

Project Map:



DRAFT

Engineering and Public Works Project Summary Sheet

Project:

DCC SS56: (100% Growth) Brookfield Dr SS (MH6536 @ 864 Brookfield to MH 6526 back of 841 Brookfield) Ph 3

Components:

1877 DCC SS56: (100% Growth) Brookfield Dr SS (MH6536 @ 864 Brookfield to MH 6526 back of 841 Brookfield) Ph 3

2026 Budget	Funding				
	General Taxation	DCC's	Water Reserves	Sewer Reserves	Other Sources
326,289	0	326,289	0	0	0
326,289	0	326,289	0	0	0

Project Description:

Upsize ~265m of 200mm to 300mm diameter on Brookfield Drive from MH6536 @ 864 Brookfield to MH 6526 back of 841 Brookfield - Ph 3

Asset Management Description of Work:

Growth - Identified as a DCC Project

Justification:

Pipe needs to be upsized from 200mm to 300mm diameter to service future growth as identified in 2014 Chase River Master Plan.

Project Map:



DRAFT

Engineering and Public Works Project Summary Sheet

DCC SS56: (60% Growth) Seventh St SS (583 Seventh St to Georgia) - Ph 1

Project:

Components:

2255 DCC SS56: (60% Growth) Seventh St SS (583 Seventh St to Georgia) - Ph 1

2018 Budget	Funding				
	General Taxation	DCC's	Water Reserves	Sewer Reserves	Other Sources
138,446	0	83,068	0	55,379	0
138,446	0	83,068	0	55,379	0

Project Description:

Upsize ~125m of 200mm to 300mm diameter on Seventh Street from 583 Seventh St to Georgia - Ph 1

Asset Management Description of Work:

Upgrades - Increased service capacity

Justification:

Pipe needs to be upsized from 200mm to 300mm diameter due to existing capacity shortfalls and to service future growth as identified in 2014 Chase River Master Plan.

Project Map:



DRAFT

Engineering and Public Works Project Summary Sheet

DCC SS57: (100% Growth) Murray SS (Esmnt Cul de sac to Bruce)

Project:

Components:

2357 DCC SS57: (100% Growth) Murray SS (Esmnt Cul de sac to Bruce)

2019 Budget	Funding				
	General Taxation	DCC's	Water Reserves	Sewer Reserves	Other Sources
75,133	0	75,133	0	0	0
75,133	0	75,133	0	0	0

Project Description:

Construct new 85m sanitary sewer main on Murray Street from end of cul-de-sac to Bruce

Asset Management Description of Work:

Upgrades - Increased service capacity

Justification:

Pipe needs to be upsized due to existing capacity shortfalls and to service future growth as identified in 2014 Chase River Master Plan.

Project Map:

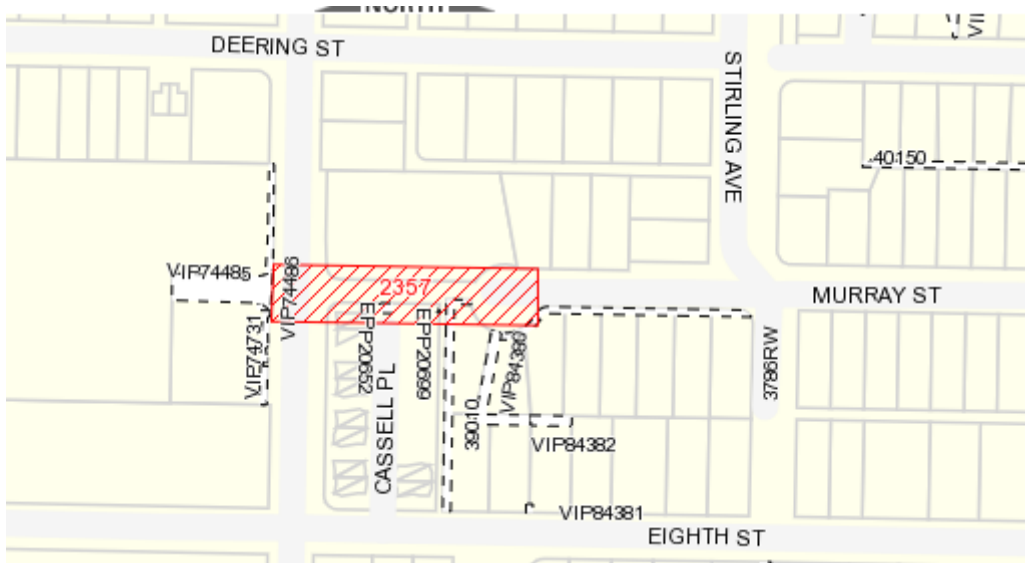

DRAFT

Engineering and Public Works Project Summary Sheet

DCC SS57: (100% Growth) Bruce Ave SS (Deering to 877 Bruce)

Project:

Components:

2356 DCC SS57: (100% Growth) Bruce Ave SS (Deering to 877 Bruce)

2019 Budget	Funding				
	General Taxation	DCC's	Water Reserves	Sewer Reserves	Other Sources
78,166	0	78,166	0	0	0
78,166	0	78,166	0	0	0

Project Description:

Upsize 200mm diameter AC on Bruce Ave from Deering to 877 Bruce.

Asset Management Description of Work:

Upgrades - Increased service capacity

Justification:

Pipe needs to be upsized due to existing capacity shortfalls and to service future growth as identified in 2014 Chase River Master Plan.

Project Map:



DRAFT

Engineering and Public Works Project Summary Sheet

DCC SS58: (66.5% Growth) Ross Esmt SS (4003 Ross Esmt to Int of Departure Bay and Rock City)

Project:

Components:

2112 DCC SS58: (66.5% Growth) Ross Esmt SS (4003 Ross Esmt to Int of Departure Bay and Rock City)

2032 Budget	Funding				
	General Taxation	DCC's	Water Reserves	Sewer Reserves	Other Sources
2,645,369	0	1,759,232	0	886,136	0
2,645,369	0	1,759,232	0	886,136	0

Project Description:

Upsize ~1.87km of 200mm/250mm/300mm to 300mm/375mm diameter in Ross Road Esmt from 4003 Ross Esmt to Intersection of Departure Bay and Rock City

Asset Management Description of Work:

Upgrades - Increased service capacity

Justification:

Pipe needs to be upsized from 200mm/250mm/300mm to 300mm/375mm diameter due to existing capacity shortfalls and to service future growth as identified in 2014 City Wide Sewer Model.

Project Map:



DRAFT

Engineering and Public Works Project Summary Sheet

DCC SS59: (100% Growth) Nottingham to Stephenson Pnt SS - PH 1

Project:

Components:

2155 DCC SS59: (100% Growth) Nottingham to Stephenson Pnt SS - PH 1

2021 Budget	Funding				
	General Taxation	DCC's	Water Reserves	Sewer Reserves	Other Sources
350,662	0	350,662	0	0	0
350,662	0	350,662	0	0	0

Project Description:

Upsize ~440m of 200mm to 300mm diameter in Esmt at 3263 Stephenson to 3250 Stephenson Point as well as in Esmt at MH4766 by 605 Nottingham to 3229 Hammond Bay - Ph 1

Asset Management Description of Work:

Upgrades - Increased service capacity

Justification:

Pipe needs to be upsized from 200mm to 300mm diameter due to existing capacity shortfalls and to service future growth as identified in 2014 City Wide Sewer Model.

Project Map:



DRAFT

Engineering and Public Works Project Summary Sheet

DCC SS59: (100% Growth) Nottingham to Stephenson Pnt SS - PH 2

Project:

Components:

2285 DCC SS59: (100% Growth) Nottingham to Stephenson Pnt SS - PH 2

2026 Budget	Funding				
	General Taxation	DCC's	Water Reserves	Sewer Reserves	Other Sources
182,354	0	182,354	0	0	0
182,354	0	182,354	0	0	0

Project Description:

Upsize 140m of 250mm to 375mm diameter from Esmt at 3250 Stephenson Point to MH 4777 at 3190 Stephenson Point

Asset Management Description of Work:

Growth - Identified as a DCC Project

Justification:

Pipe needs to be upsized from 250mm to 375mm diameter to service future growth as identified in 2014 City Wide Sewer Model.

Project Map:



DRAFT

Engineering and Public Works Project Summary Sheet

DCC SS59: (100% Growth) Nottingham to Stephenson Pnt SS - PH 3

Project:

Components:

2286 DCC SS59: (100% Growth) Nottingham to Stephenson Pnt SS - PH 3

2031 Budget	Funding				
	General Taxation	DCC's	Water Reserves	Sewer Reserves	Other Sources
561,613	0	561,613	0	0	0
561,613	0	561,613	0	0	0

Project Description:

Upsize ~555m of 200mm to 300mm diameter from MH 4782 at 3229 Hammond Bay to 3263 Stephenson Point as well as in Esmt by Nottingham from Ham Bay to MH4766 at 605 Nottingham

Asset Management Description of Work:

Growth - Identified as a DCC Project

Justification:

Pipe needs to be upsized from 200mm to 300mm diameter to service future growth as identified in 2014 City Wide Sewer Model.

Project Map:

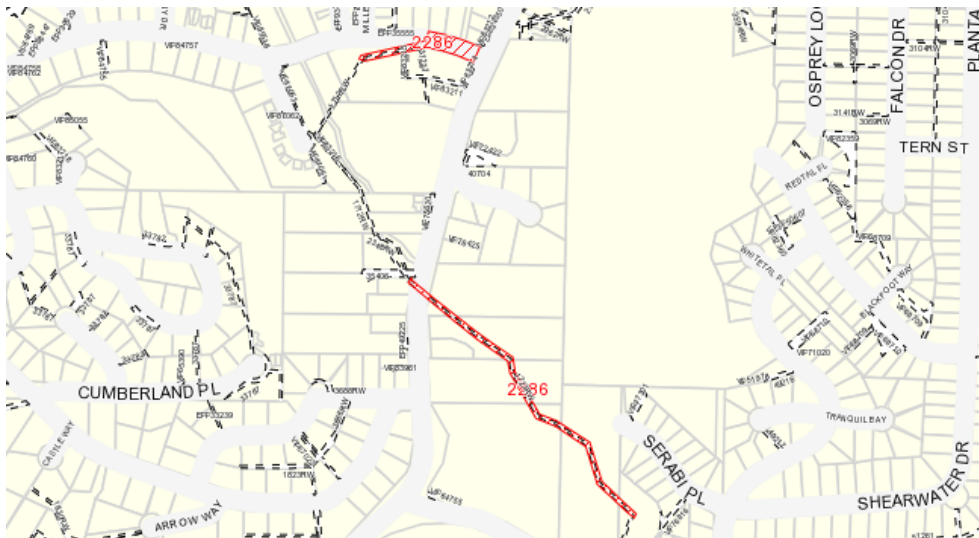

DRAFT

DCC SS60: (80% Growth) Big Bear Ridge SS (Noye Rd to Godfrey)

Components:

1664 DCC SS60:
(80% Growth) Big
Bear Ridge SS (Noye
Rd to Godfrey)

Upsize ~225m of 200mm to 300mm diameter on Big Bear Ridge from Noye to Godfrey

Upgrades - Increased service capacity

Pipe needs to be upsized from 200mm to 300mm diameter due to existing capacity shortfalls and to service future growth as identified in 2012 Millstone Master Plan.

DRAFT

Engineering and Public Works Project Summary Sheet

Project:

DCC SS61: Bradley St SS (529 Bradley to Holly)

Components:

	2017	Funding				
	Budget	General Taxation	DCC's	Water Reserves	Sewer Reserves	Other Sources
753 DCC SS 61: Bradley St SS (529 Bradley to Holly)	188,976	0	170,078	0	18,898	0
	188,976	0	170,078	0	18,898	

Project

Description:

Upsize 168m with 300mm diameter on Bradley Street from 529 Bradley to Holly

Asset Management Description of Work:

Upgrades - Increased service capacity

Justification:

Approximately 168m of pipe to be replaced with 300mm diameter as specified by the 2014 City Wide Sewer Model. CCTV video shows that other pipes in this area are in deteriorating condition and should be replaced as well.

Project Map:



Engineering and Public Works Project Summary Sheet

Project: DCC SS61: Mount Benson SS (EN Rail to Terminal)

Components:

2057 DCC SS61: Mount Benson SS (EN Rail to Terminal)

2017	Funding				
Budget	General Taxation	DCC's	Water Reserves	Sewer Reserves	Other Sources
320,821	0	288,739	0	32,082	0
320,821	0	288,739	0	32,082	0

Project Description:

Upsize ~280m of 250mm to 375mm diameter on Mount Benson from EN Rail to Terminal

Asset Management Description of Work:

Upgrades - Increased service capacity

Justification:

Approximately 275m of pipe to be upsized from 250mm to 375mm diameter due to existing capacity shortfalls and to service future growth as specified by the 2014 City Wide Sewer Model.

Project Map:



Engineering and Public Works Project Summary Sheet

DCC SS62: (90% Growth) Westdale Rd Esmt SS (Westdale to Ham Bay)

Project:

Components:

1505 DCC SS62 (90% Growth) Westdale Rd Esmt SS (Westdale to Ham Bay)

2017 Budget	Funding				
	General Taxation	DCC's	Water Reserves	Sewer Reserves	Other Sources
258,000	0	232,200	0	25,800	0
258,000	0	232,200	0	25,800	0

Project Description:

New installation of 95m of 200mm PVC pipe on Westdale, and replacement of 220m of 150mm/200mm PVC pipe on Westdale and Esmt.

Asset Management Description of Work:

Upgrades - Increased service capacity

Justification:

The pipe needs to be upsized from 300mm to 375mm diameter due to existing capacity shortfalls and to service future growth as identified in the 2014 City Wide Sanitary Sewer model. Confirmed new route to convey wastewater to RDN trunk that does not require upsizing pipes in Westdale Rd Esmt and Hammond Bay Road disturbance.

Project Map:



DRAFT

Engineering and Public Works Project Summary Sheet

DCC SS63: (20% Growth) Fillinger Crescent SS (5100 Fillinger to 5190 Fillinger)

Project:

Components:

1413 DCC SS63: (20% Growth)
Fillinger Crescent SS (5100
Fillinger to 5190 Fillinger)

2018 Budget	Funding				
	General Taxation	DCC's	Water Reserves	Sewer Reserves	Other Sources
1,473,200	0	294,640	0	1,178,560	0
1,473,200	0	294,640	0	1,178,560	0

Project Description:

Upsize 350m of 150mm/250mm to 375mm diameter on Fillinger Crescent from 5100 to 5190 Fillinger

Asset Management Description of Work:

Upgrades - Increased service capacity

Justification:

The CCTV video of the san on Fillinger shows that it is settling and ponding which is causing O&M issues. As well, pipes need to be upsized from 250mm to 375mm diameter due to existing capacity shortfalls and to service future growth as identified in 2014 City Wide Sewer Model.

Project Map:

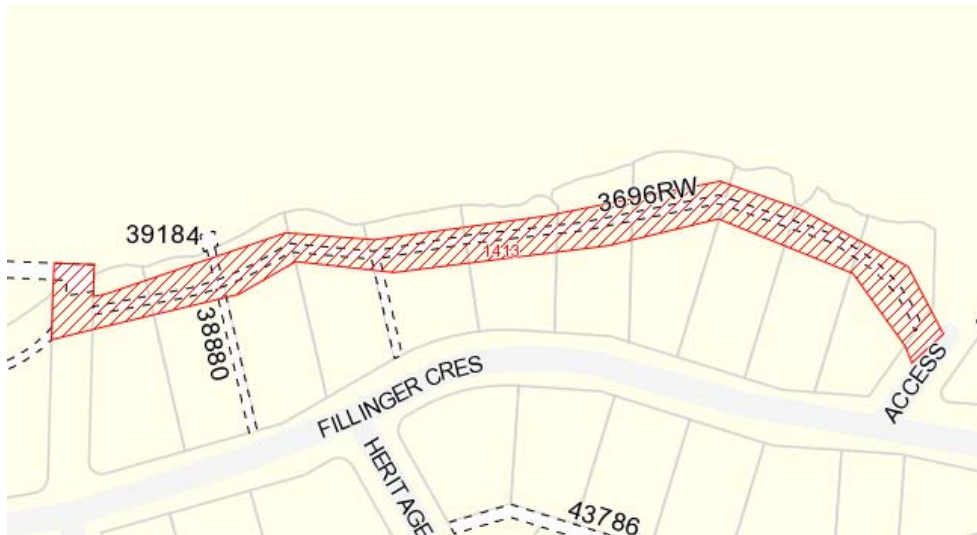

DRAFT

Engineering and Public Works Project Summary Sheet

DCC SS64: (100% Growth) Nova Esmnt Area SS

Project:

Components:

2329 DCC SS64: (100% Growth) Nova Esmnt Area SS

2018 Budget	Funding				
	General Taxation	DCC's	Water Reserves	Sewer Reserves	Other Sources
187,960	0	187,960	0	0	0
187,960	0	187,960	0	0	0

Project Description:

New 210m relief sewer on Seventh Street from Georgia to Bruce due to capacity issues.

Asset Management Description of Work:

Upgrades - Increased service capacity

Justification:

Pipe needs to be upsized due to existing capacity shortfalls and to service future growth as identified in 2016 Seventh & Murray Relief Analysis TM.

Project Map:

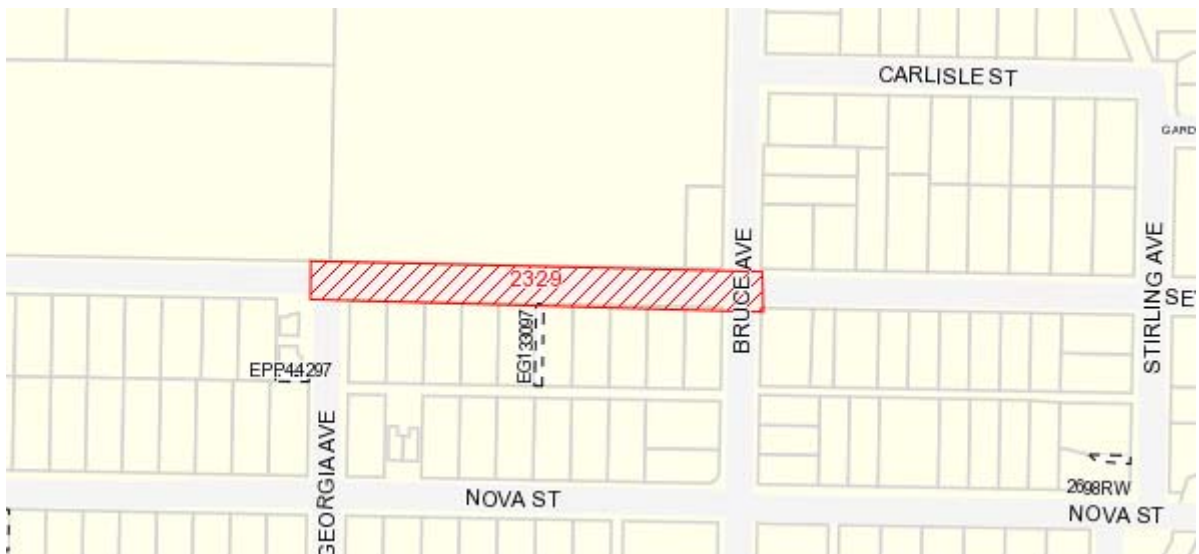

DRAFT