

PEDESTRIAN AREA PATTERNS ONLY

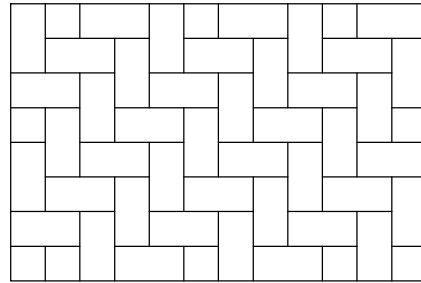

PATTERNS TO BE USED FOR VEHICULAR OR PEDESTRIAN TRAFFIC.

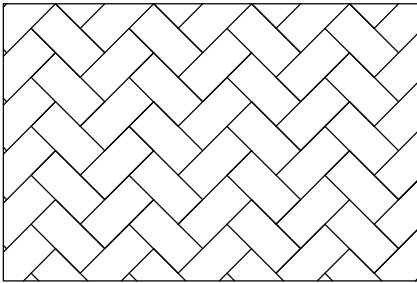
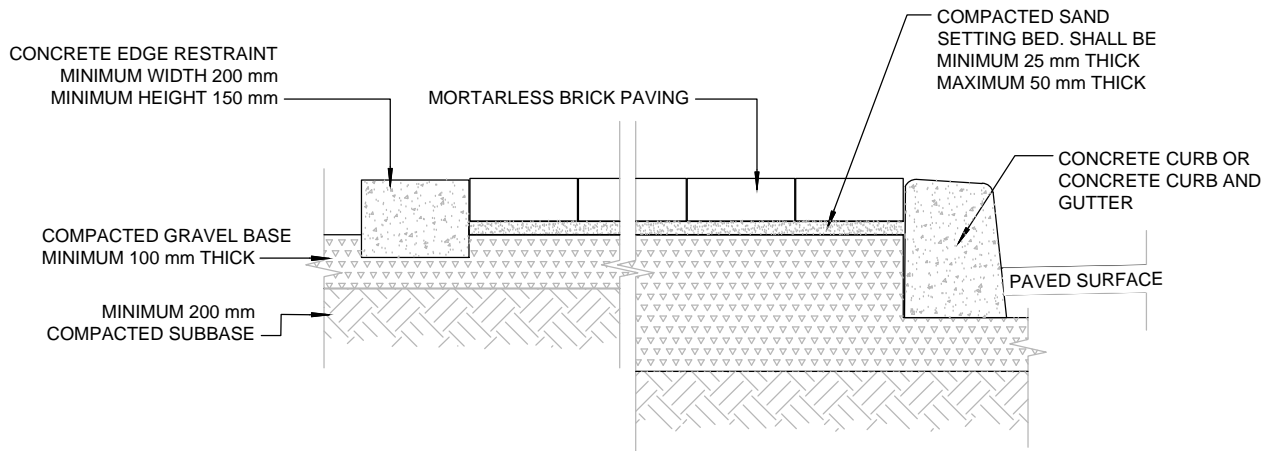

**FLEXIBLE BASE DETAIL**

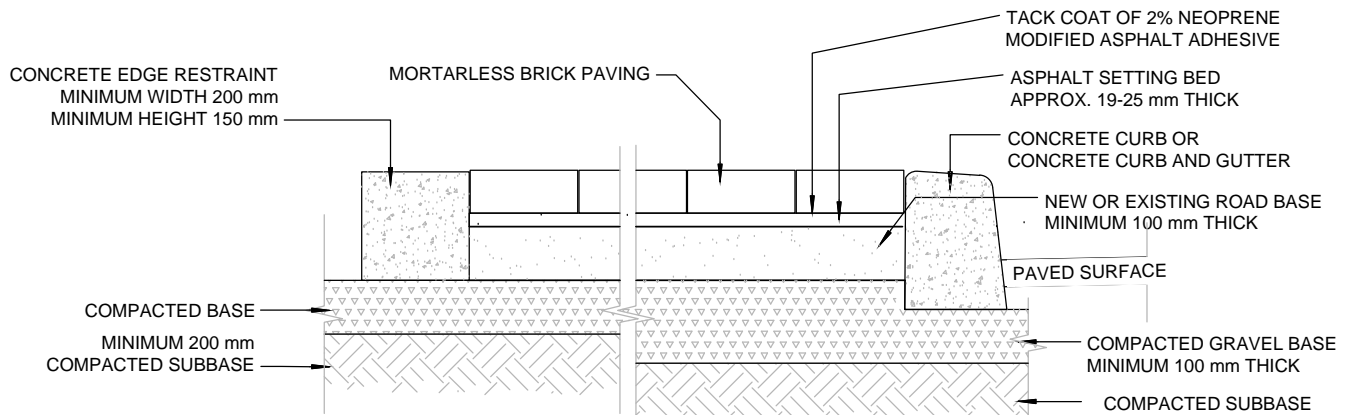

**SEMI-RIGID BASE DETAIL**

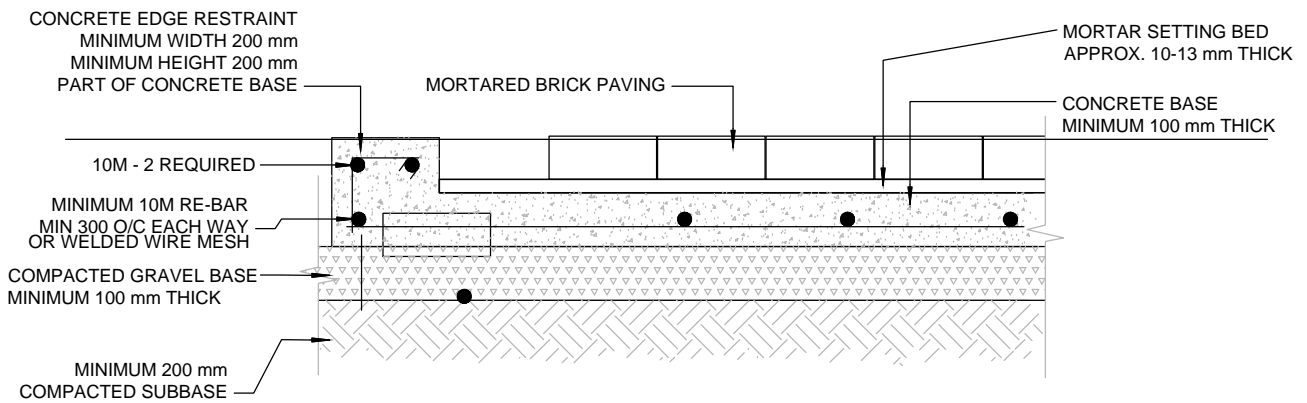

**RIGID BASE DETAIL - TO BE USED FOR CROSSWALKS**

**NOTES:**

1. MIN. BRICK PAVER THICKNESS SHALL BE 80 mm WHEN INSIDE THE ROADWAY RIGHT OF WAY.
2. SURFACE OF BRICK PAVERS SHALL BE 3 to 6 mm ABOVE EDGE RESTRAINTS.
3. CONCRETE CURBS, EDGE RESTRAINTS AND FOOTINGS SHALL CONFORM TO SECTION 8 - CURBS AND SIDEWALKS.
4. ALL DIMENSIONS ARE IN mm UNLESS OTHERWISE STATED.
5. ALL CONCRETE TO BE REINFORCED AS REQUIRED.



BASE PAVING DETAILS  
FLEXIBLE, SEMI-RIGID &  
RIGID BASE

Scale: NTS  
Created: MAY 2013  
Rev Date: NOV 2016  
Dwg No: BP-2

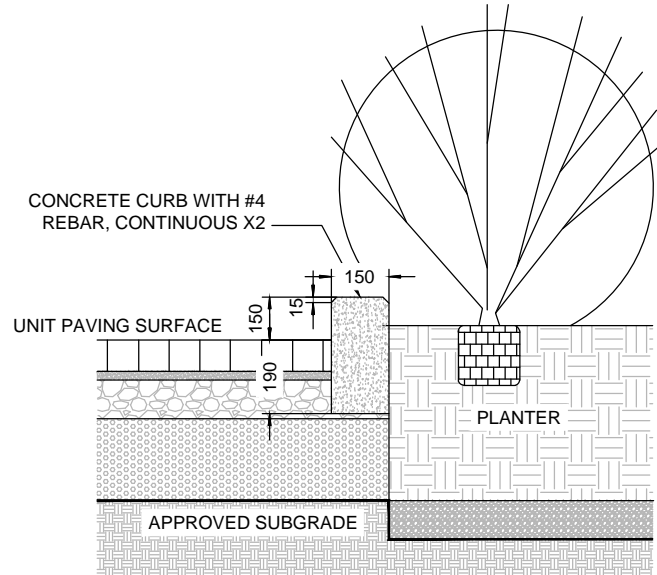

**NOTES:**

1. INSTALL AS PER MANUFACTURERS SPECIFICATIONS.
2. CHAMFER EXPOSED CONCRETE EDGES AT 45 DEGREES AT THE LENGTH PROVIDED.
3. ALL CONCRETE TO BE REINFORCED AS REQUIRED.
4. ALL DIMENSIONS ARE IN mm UNLESS OTHERWISE SPECIFIED.

**UNIT PAVING AT PLANTER EDGE - PLANTER CURB**

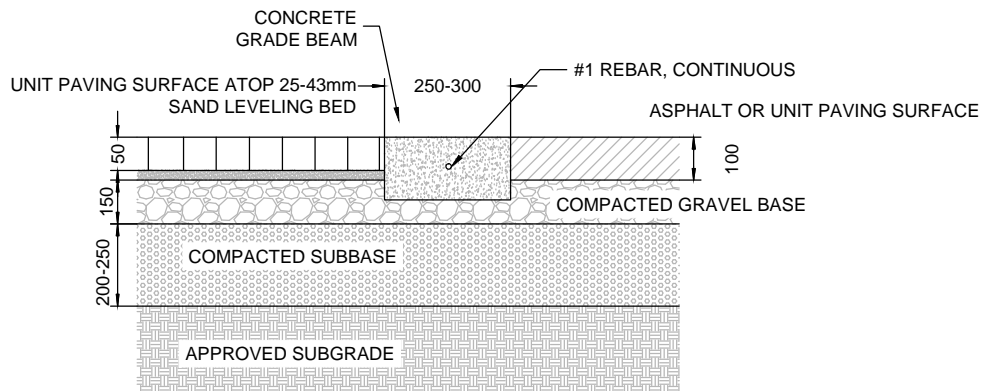

**NOTES:**

1. INSTALL AS PER MANUFACTURERS SPECIFICATIONS.
2. A COMPACTED SUBBASE DEPTH OF 25mm SHALL BE USED ONLY AT DESIGNATED FREQUENT VEHICULAR AREAS.
3. ALL ASPHALTIC SURFACES TO MEET CITY OF NANAIMO ENGINEERING STANDARDS AND SPECIFICATIONS SECTION 12.
4. ALL CONCRETE TO BE REINFORCED AS REQUIRED.
5. ALL DIMENSIONS ARE IN mm UNLESS OTHERWISE SPECIFIED.

**UNIT PAVING AT ASPHALT/UNIT PAVING EDGE GRADE BEAM**

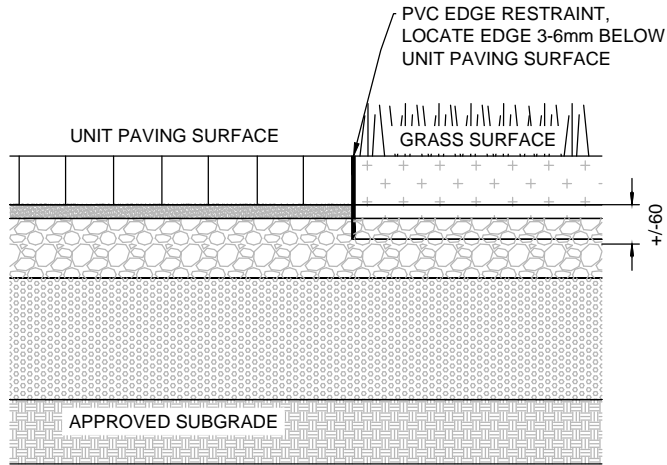

NOTES:

1. INSTALL AS PER MANUFACTURERS SPECIFICATIONS.
2. ALL DIMENSIONS ARE IN MM UNLESS OTHERWISE SPECIFIED

UNIT PAVING AT GRASS EDGE

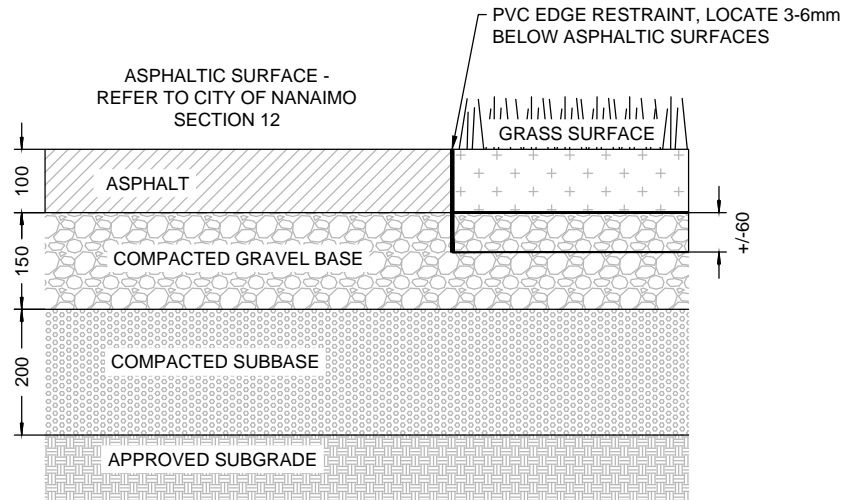

NOTES:

1. ALL DIMENSIONS ARE IN mm UNLESS OTHERWISE SPECIFIED
2. ASPHALT PAVING AT GRASS EDGE DETAIL SHALL BE USED ONLY WHEN APPROVED BY THE CITY ENGINEER.

ASPHALT PAVING AT GRASS EDGE