

# LOCATION PLAN

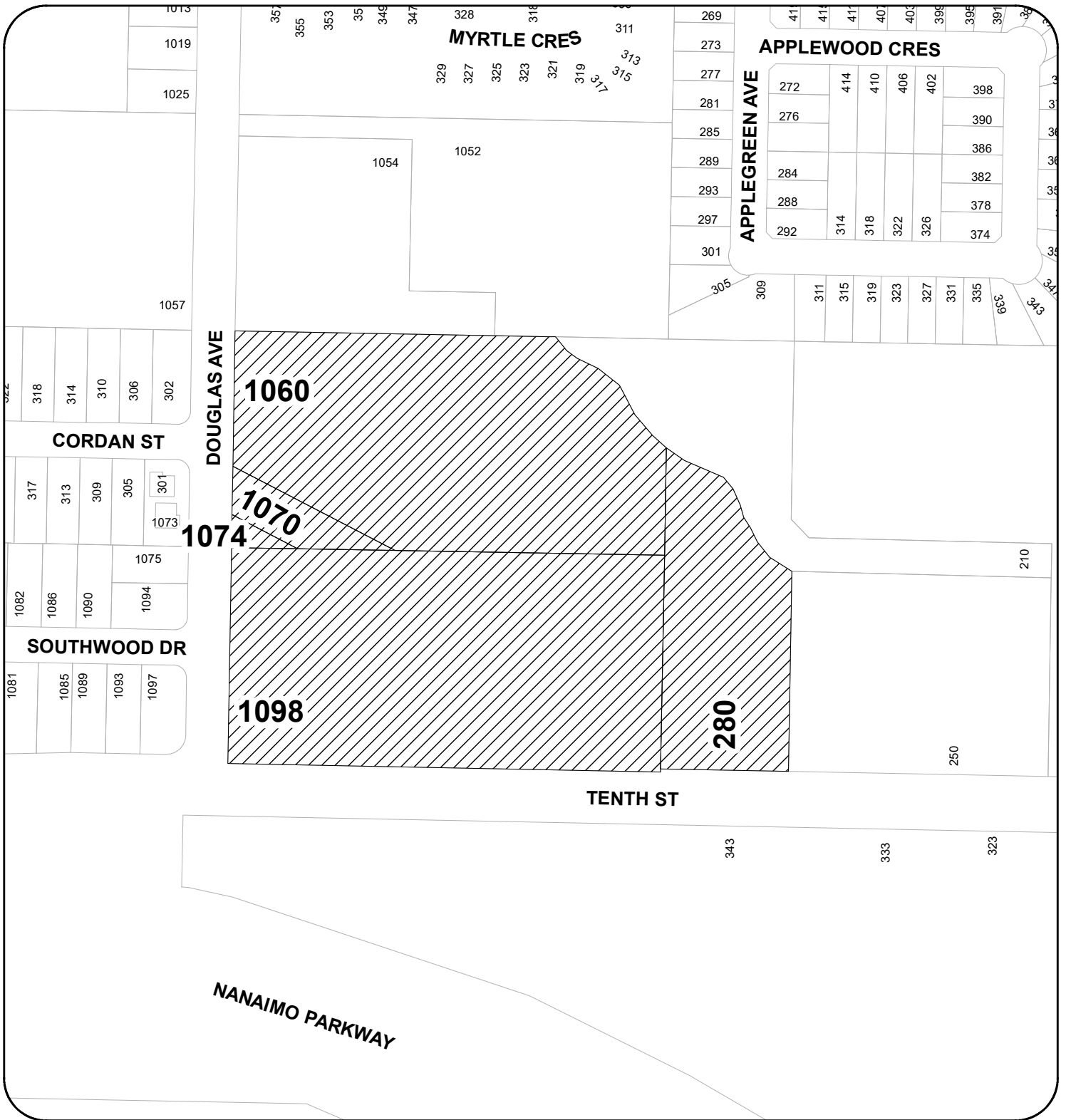

## COVENANT AMENDMENT NO. CA000013

# LOCATION PLAN



CIVIC: 1060, 1070, 1074, 1098 DOUGLAS AVENUE, & 280 TENTH STREET  
LEGAL: LOTS 1, 2 & 3, SECTION 1,  
NANAIMO DISTRICT, PLAN 2903 & EPP20125  
EXCEPT PART IN PLAN EPP17767 THAT IS PARK  
AND SECTION 5, RANGE 13, SECTION 1, NANAIMO DISTRICT, PLAN 630